



1997-2006 Jeep Wrangler TJ Hood Hold Downs

D-JP-190021-LK – Locking Hood Hold Down

D-JP-190021-K – Hood Hold Down

***Note** - Designed to work with stock hood and fender and may not be compatible with some aftermarket hoods, fenders, or fender flairs

The D-JP-190021-LK is shown

TOOLS NEEDED FOR INSTALLATION

5MM ALLEN WRENCH

4 MM ALLEN WRENCH

1/4" DRIVE RATCHET WITH 10MM AND 13MM SOCKETS

3" & 6" EXTENSION FOR 1/4" DRIVE RATCHET

(2) 13MM OPEN ENDED WRENCHES OR SMALL ADJ. WRENCHS

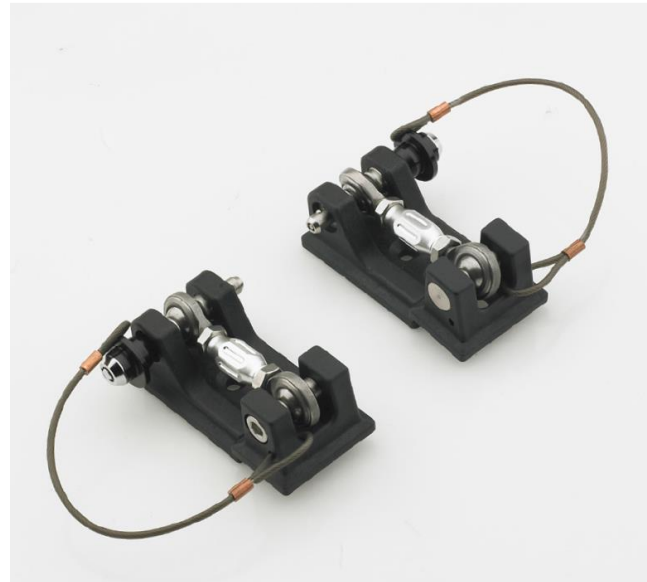

Kit Includes (Before starting, check that your kit includes everything listed below)

| Hardware | | |
|------------|--|---|
| | M6-1.0 X 16MM STAINLESS STEEL FLAT HEAD ALLEN SCREW | 4 |
| | M6-1.0 NYLOC NUT | 4 |
| | M6 FLAT WASHER | 4 |
| | M8-1.25 X 16MM STAINLESS STEEL FLAT HEAD ALLEN SCREW | 2 |
| | M8-1.25 NYLOCK NUT | 2 |
| | M8 FLAT WASHER | 2 |
| Assemblies | | |
| 1 | SPACER, BOLT END | 4 |
| 2 | ADJUSTMENT SLEEVE, 30MM HEX | 2 |
| 3 | LOWER SUB-ASSY W/ LANYARD & PIN | 2 |
| 4 | M8-125 RH JAM NUT | 2 |
| 5 | M8-125 LH JAM NUT | 2 |
| 6 | UPPER SUB-ASSY | 2 |
| 7 | SHOULDER BOLT M6-1.0 | 2 |
| 8 | NEOPRENE GASKET, UPPER BRACKET | 2 |
| 9 | NEOPRENE GASKET, LOWER BRACKET | 2 |
| 10 | M8 HEIM JOINT W/ M8-1.25 RH THREAD | 2 |
| 11 | M8 HEIM JOINTW/ M8-1.25 LH THREAD | 2 |

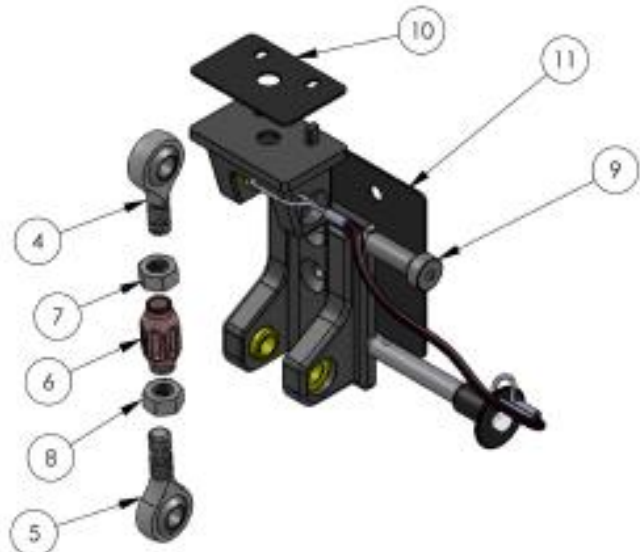

Step #1

Open Hood



Step #2

Using a 10mm socket or wrench, remove two nuts securing stock hood latch to hood and remove from both sides of vehicle

Step #3

Install the DV8 Offroad Hood brackets on both sides of hood using allen head M6 bolts, washers and nuts supplied. (4mm allen wrench and 10mm socket) Orient bracket so that bushings are towards the top half of the bracket when installed. Make sure to place rubber pad between hood and bracket. Tighten securely.





Step #4

Using a 15mm socket and ratchet remove original lower half of hood hold down brackets from both front fenders.

****Do not remove rubber bumper on fender.**

Step #5

Using a 4mm allen wrench remove billet turn buckle from DV8 Offroad Fender Bracket.

****Be careful not to lose 2 small bushings.**



Step #6

Using a 5mm allen wrench and 13mm socket with ratchet install DV8 Offroad fender bracket to fender using M8 flat head bolt, washer and nut provided.

Make sure to place rubber pad between bracket and fender.

There is a difference between the two brackets, decided if you want the bolt head facing forward or reverse and if you want the lanyard facing forward or reverse and install the brackets accordingly side to side. We install them with the lanyard facing forward on the vehicle, but this will not affect the performance and is purely a personal choice



Step #7

Install turn buckle back into bracket using 4mm allen wrench and bolt removed previously.

Make sure to slide a spacer on both sides of the heim joint.

Step #8

Finish any previous steps on both sides of vehicle and make sure turn buckle is flipped outwards and resting on fender as shown above.

Close Jeep hood



Step #9

Line up turnbuckle and install quick release pin. Direction of the quick release pin is user preference and it can be installed from the front or the back.

SETUP

1. Make sure jam nuts are threaded all the way against the heim joints as seen in the previous picture (Step #9).
2. Gently apply downward pressure to hood while turning billet aluminum turn buckle to adjust hood down until it contacts the rubber pad.
 - a. Adjustment should be set to personal preference, but we have found that spinning the turnbuckle until the quick release pin is almost difficult to pull out works best.
 - b. With it adjusted to this tension we can gently push down on the hood to relieve the pressure on the pin and pull it out at the same time.
3. Once adjusted to your preferred tension, use two 13mm wrenches to tighten the jam nuts on the turnbuckle against the billet aluminum center piece.
 - a. Once adjusted properly you should not need to use turnbuckle to open and close your hood.

ALWAYS MAKE SURE TURNBUCKLES ARE FLIPPED OUTWARD BEFORE CLOSING HOOD TO AVOID DAMAGE!

