

INSTALLATION GUIDE

HORIZONTAL HI LIFT

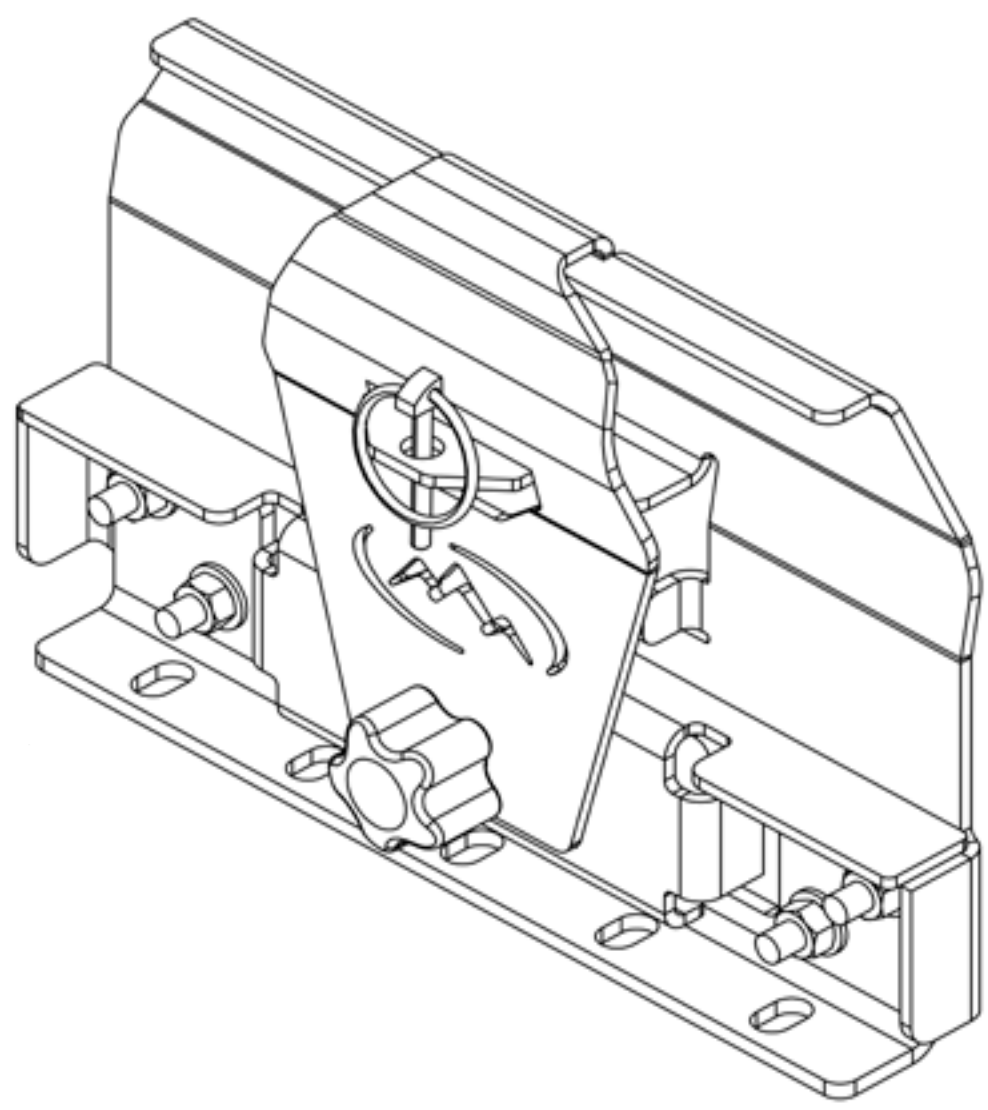

CONTENTS

FOR USE ON GEN 2 & GEN 3 STC TIRE CARRIER SWING ARMS

HARDWARE

ITEM	QTY
Horizontal Hi Lift	1
Horizontal Hi Lift Base Plate	1
Latch	1
Hardware	
5/16"-18 X 1" Carriage Bolt	4
5/16"-18 Nyloc Nut	4
5/16" USS Washer	4
3/8"-16 X 1 1/4" Hex Cap Bolt	3
3/8"-16 Nyloc Nut	3
3/8" USS Wssher	6
3/8"-16 Clip Nut	1
Linch Pin	1
Lobe Knob	1

SKILL LEVEL - 2 STARS



1 STAR

EASY - No tools required

2 STARS

BASIC - Requires standard tools, basic mechanical knowledge and understanding

3 STARS

MODERATE - Requires standard tools. Some drilling and/or cutting.

4 STARS

ADVANCED - Requires speciality tools. Drilling, cutting, and/or welding

5 STARS

EXPERT - Professional installation recommended.

DISCLAIMER

Expedition One is not responsible for any damages to vehicle or injury.
We always recommend professional assistance when installing our vehicle products.

Always follow safety precautions including the use safety gear and devices.

HORIZONTAL HI LIFT

1 MOUNTING

Mount the Hi Lift using the provided 3/8" hardware to secure the base plate to the top of the Gen 3 tire carrier as shown below. The open latch side will face the vehicle or back side of the arm away from the tire for access.

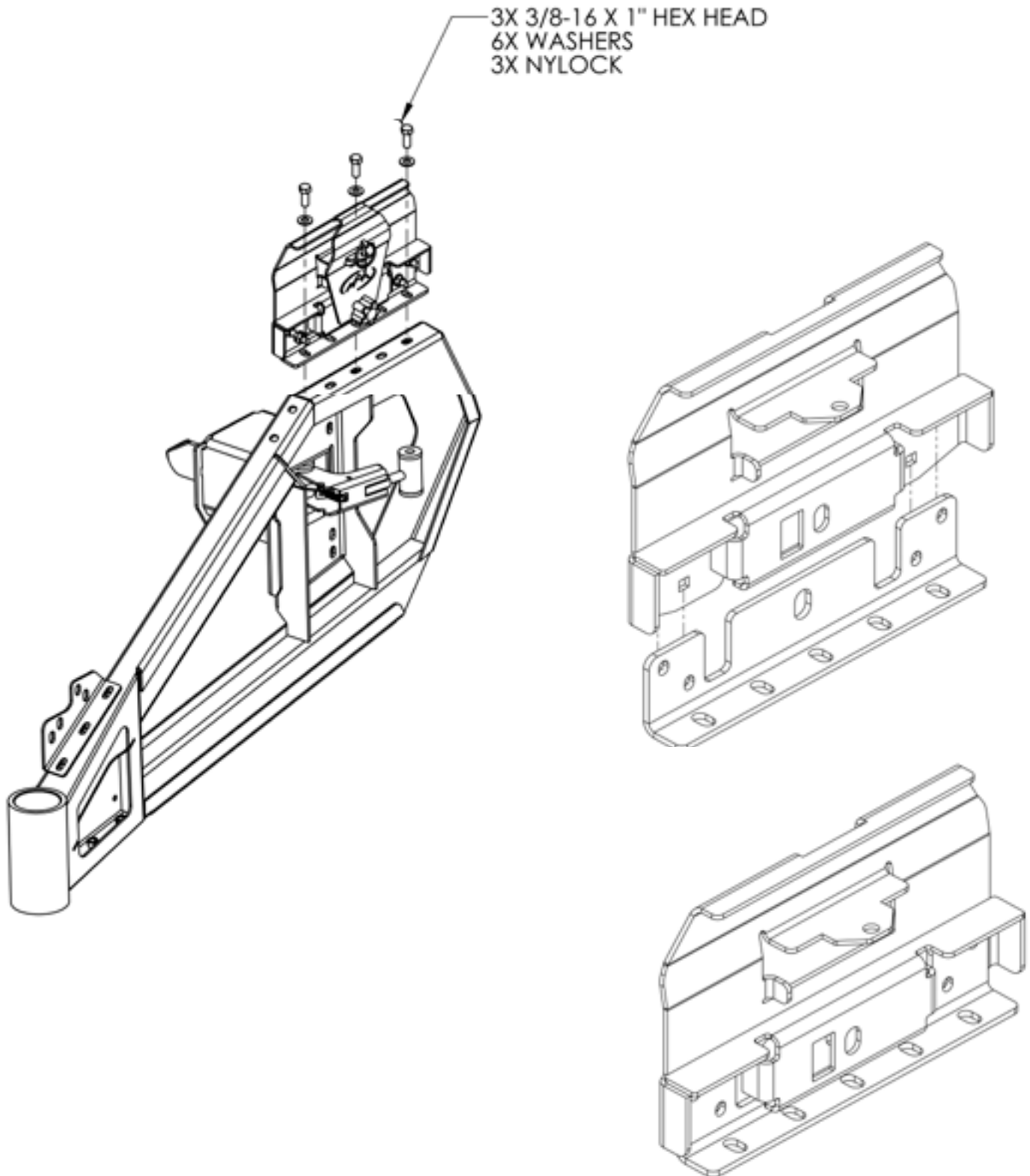

NOTE

GEN 2 arm mounting shown below as the only difference between arm mounting. Use the provided matching triangle mount per vehicle and install using 3/8" hardware.

JK Wrangler - Gen 2 STC Arm

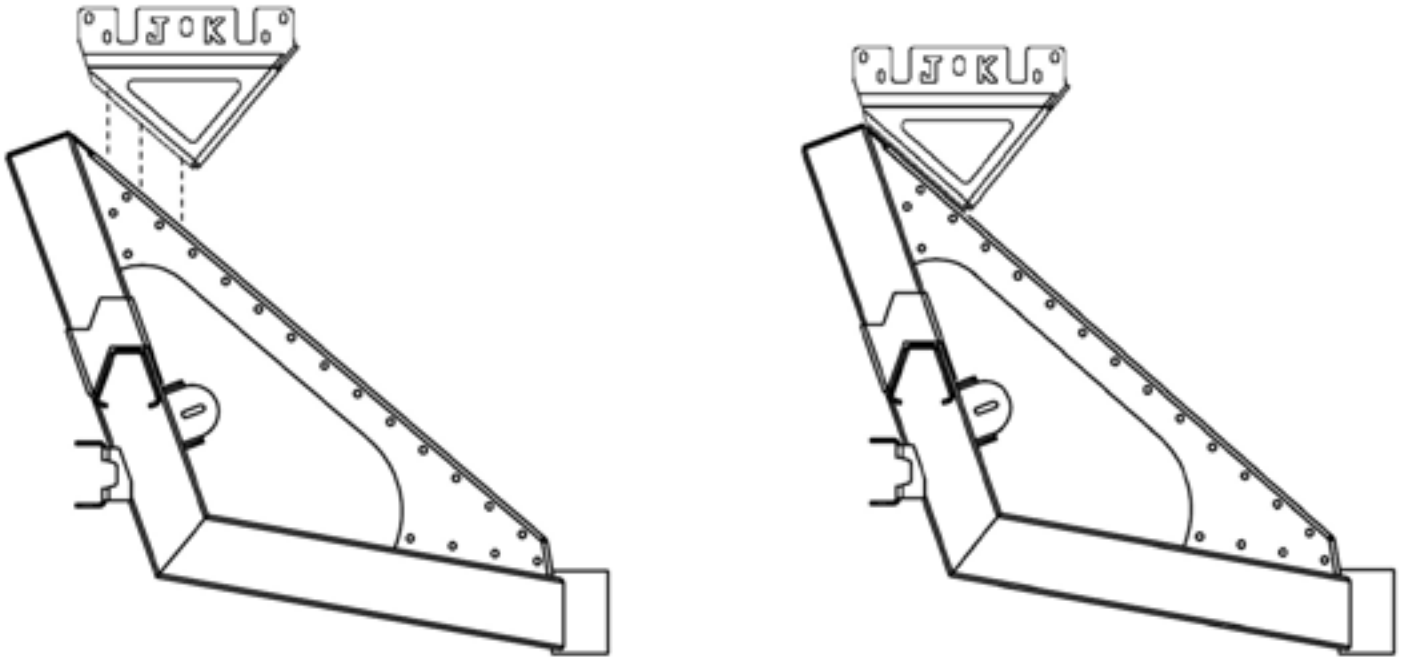

FJ Cruiser - Gen 2 STC Arm

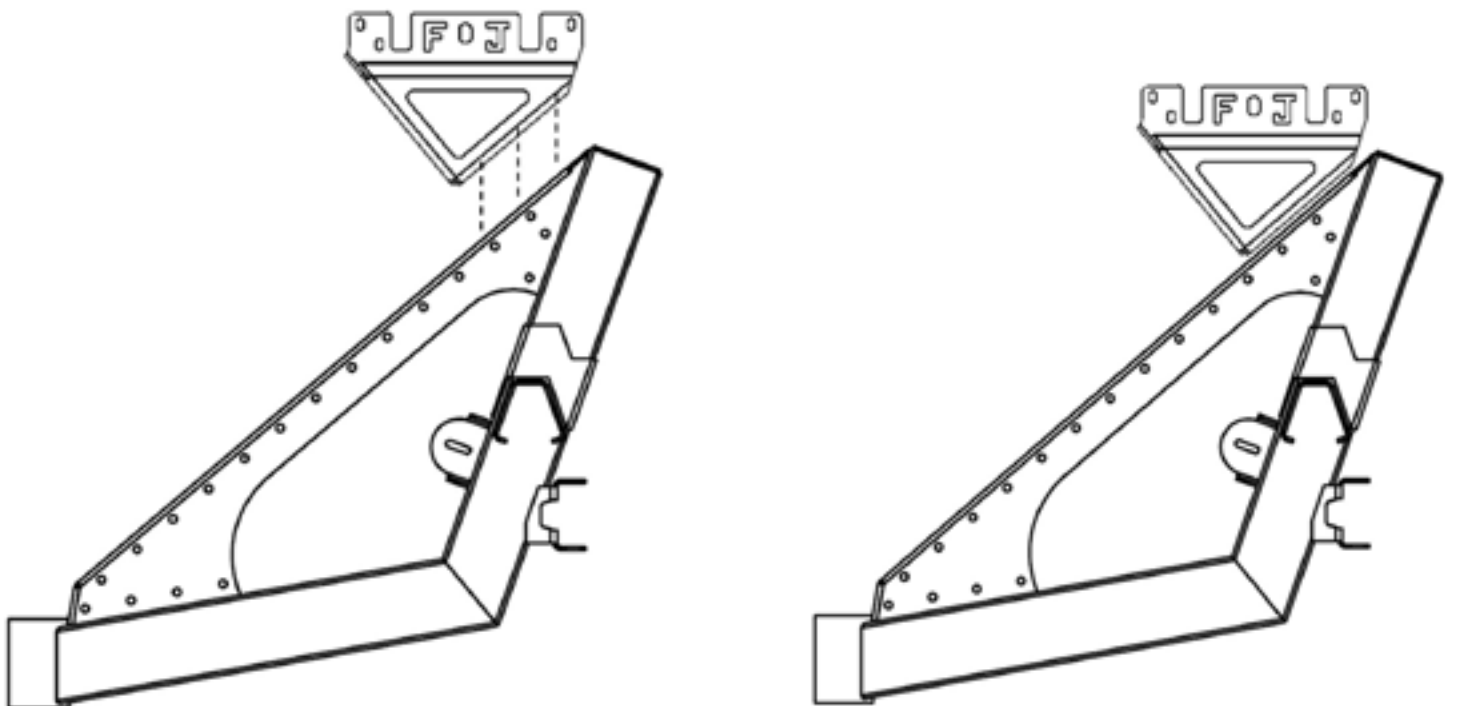

2 HORIZONTAL HI LIFT ASSEMBLY

Assemble the Horizontal Hi Lift as shown by mounting the Hi Lift to the base plate using the 3/8" hardware.

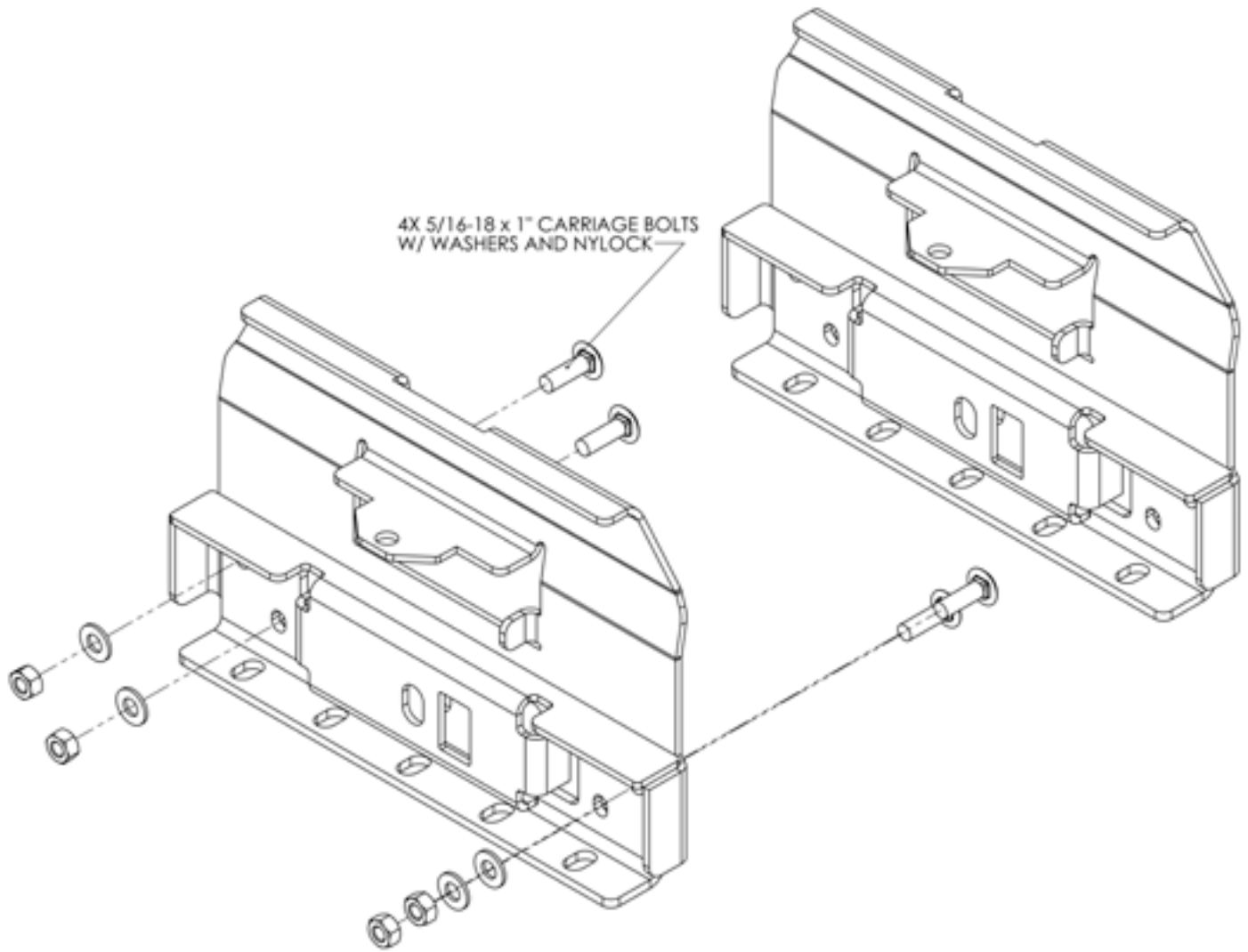

3 LATCH ATTACHMENT AND HARDWARE

Insert the latch into the slot located on the top of the Hi Lift as shown. Mount and attach your Hi Lift with the provided hardware.

