

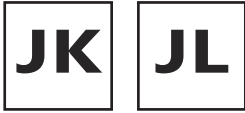

*DESTROYER SERIES*



ROOF RACK  
SLIDING RACK  
CROSS MEMBER



**WEB LINK:** <http://lodoffroad.com/assets/pdfs/JCM0796-97 SLIDING RACK CROSS MEMBER.pdf>

**\*VERIFY YOU HAVE ALL THE COMPONENTS BEFORE STARTING THE INSTALLATION. REFER TO THE ENGINEERING DRAWINGS AT THE END OF THIS DOCUMENT FOR A COMPLETE PARTS LIST\***

**\*PLEASE READ THROUGH THE ENTIRE INSTRUCTION SET BEFORE BEGINNING THE INSTALLATION PROCESS\***

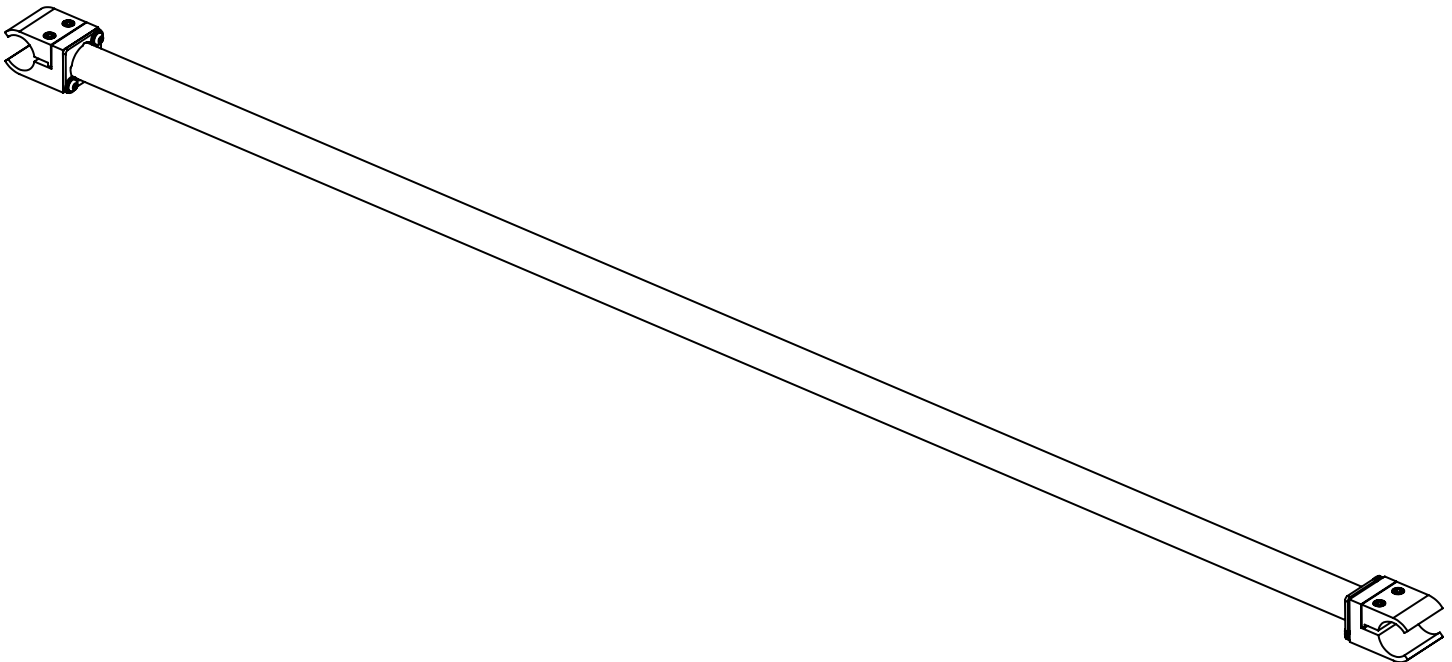

ITEM NO.	PART NUMBER	DESCRIPTION	QTY.
1	2JRR0704-76	BAR CLAMP TOP	2
2	2JRR0704-75	BAR CLAMP BOTTOM	2
3	4JCM0796-01	SLIDING RACK CROSS MEMBER WELDMENT	1
4	SHSCS252020CZ	SHSCS 1/4-20 X 1.25 ZINC PLATE	4
5	BHSCS252008ZP	BHSCS 1/4-20 X 0.50 ZINC PLATE	4
6	FW1209ZP	FLAT WASHER #12 X .56" ZINC PLATED	4

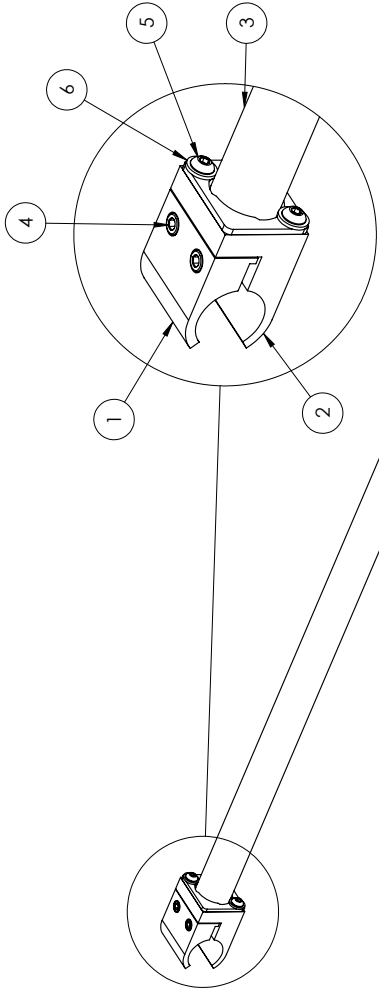

- NOTES:**
- JCM0796 = BARE STEEL OPTION
  - JCM0797 = BLACK POWDER COAT OPTION

UNLESS OTHERWISE SPECIFIED:		NAME	DATE
DIMENSIONS ARE IN INCHES	DRAWN	MCH	1/5/2018
ANGULAR DIMENSIONS	CHECKED		
TWO PLACE DECIMAL ±0.015	ENG APPR.		
THREE PLACE DECIMAL ±0.005	MFG APPR.		
<b>PROPRIETARY AND CONFIDENTIAL</b>		MATERIAL:	
THIS INFORMATION CONTAINED IN THIS DRAWING IS THE SOLE PROPERTY OF LOD LLC. ANY REPRODUCTION IN PART OR AS A WHOLE WITHOUT THE WRITTEN PERMISSION OF LOD LLC IS PROHIBITED.		N/A	
		FINISH:	
		SEE NOTES	
		ECCO:	
		DWG. NO.	JCM0796
			JCM0797
		REV	A
		SCALE: 1:4	SHEET SIZE: B
			SHEET 1 OF 1



LOD LLC.

DESCRIPTION:  
SLIDING RACK CROSS MEMBER



**JK/JL Jeep  
DESTROYER SERIES  
ROOF RACK  
SLIDING RACK CROSS MEMBER  
SHIPPING SHEET**

Packaged by:

\_\_\_\_\_

On:

\_\_\_\_\_

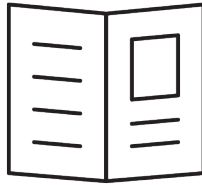

Instruction  
Booklet

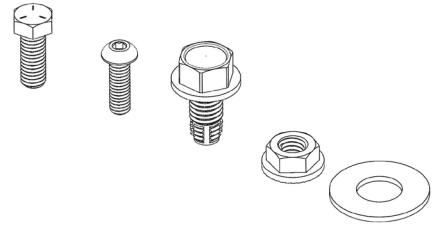

BOLT KIT  
(may vary)

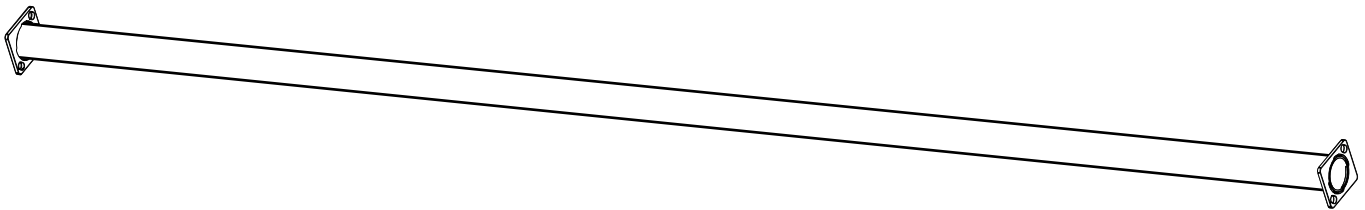

SLIDING RACK CROSS MEMBER WELDMENT  
4JCM0796-01

(x1)

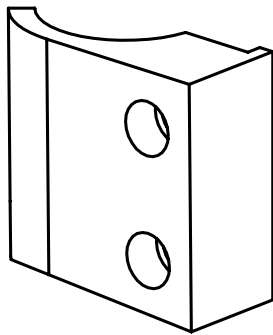
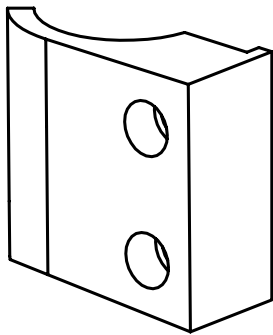

BAR CLAMP TOP  
2JRR0704-76  
(x2)

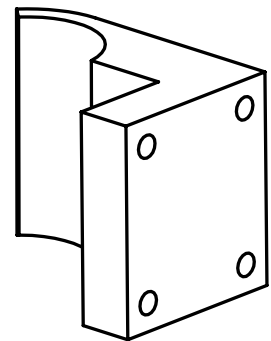
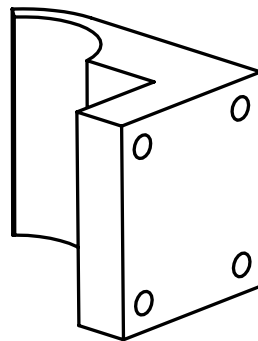

BAR CLAMP BOTTOM  
2JRR0704-75  
(x2)





**JK/JL Jeep**  
**DESTROYER SERIES**  
ROOF RACK  
SLIDING RACK CROSS MEMBER  
BOLT KIT

Packaged by:

\_\_\_\_\_

On:

\_\_\_\_\_

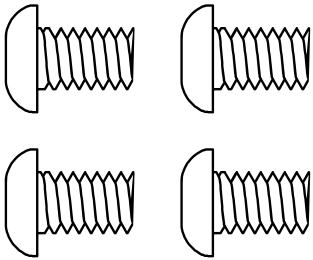

BUTTON HEAD  
1/4-20 X 0.50  
**(x4)**

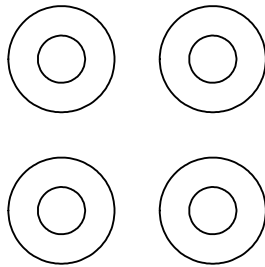

FLAT WASHER  
#12 X .56"  
**(x4)**

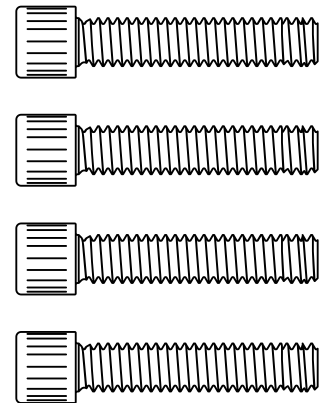

SOCKET HEAD SCREW  
1/4-20 X 1.25  
**(x4)**

