



# DESTROYER FRONT BUMPER INSTALL

**JK**



## **STEP 1:** GATHER YOUR TOOLS AND LAY OUT YOUR PARTS...

### **Tools Required:**

- Utility knife
- 11/16" Deep socket
- Ratchet
- 11/16" Crescent wrench
- Ratchet Extension
- 1/4" socket
- Electrical tape

### **Hardware Provided:**

- Eight (7/16"-14 x 1.5") mounting bolts
- Eight (7/16"-14) flange nuts
- Four (7/16") washers
- Eight (#8 Size) screws

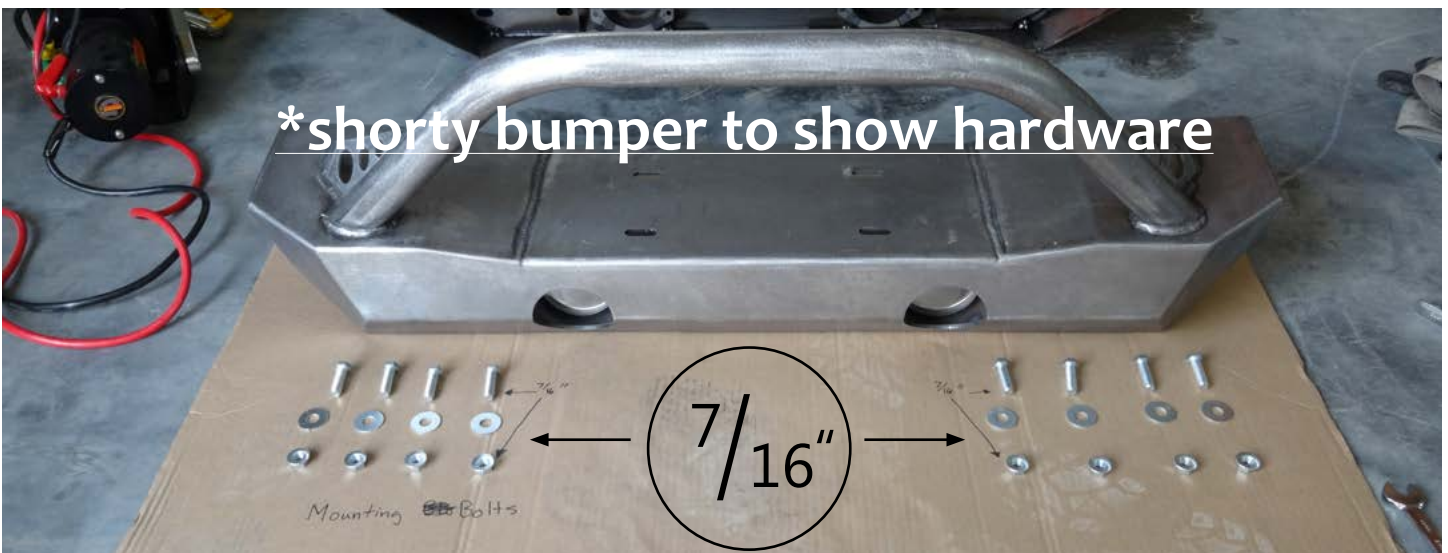



## **STEP 2 :**

TURN THE BUMPER AWAY FROM YOU, AND INSERT THE FACTORY FOGLIGHTS.

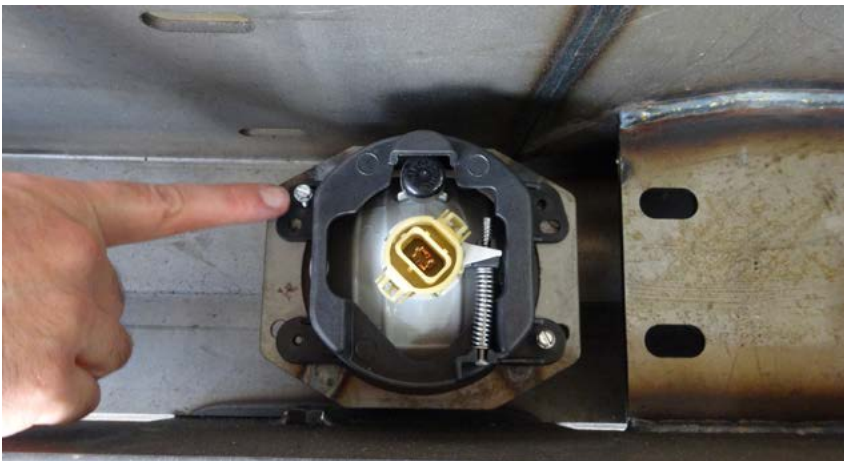

## **STEP 3 :**

LINE UP THE HOLES AND ATTACH THE LIGHTS WITH THE (8) PROVIDED SELF-TAPPING #8 HEX HEAD SCREWS.



## **STEP 4 :**

START BY INSERTING THE TOP CORNER BOLTS ON EACH SIDE, LEAVING THEM HANGING IN PLACE



## **STEP 5 :**

LOCATE THE MOUNTING HOLES AND LIFT UP THE BUMPER TO ALIGN THE MOUNTING HOLES ON THE BUMPER AND THE VEHICLE FRAME.



## **STEP 6 :**

GENTLY SLIDE THE BUMPER OVER THE FRAME MOUNTS AND SLOWLY MOVE IT FORWARD, LETTING IT REST ON TOP OF THE FRAME.

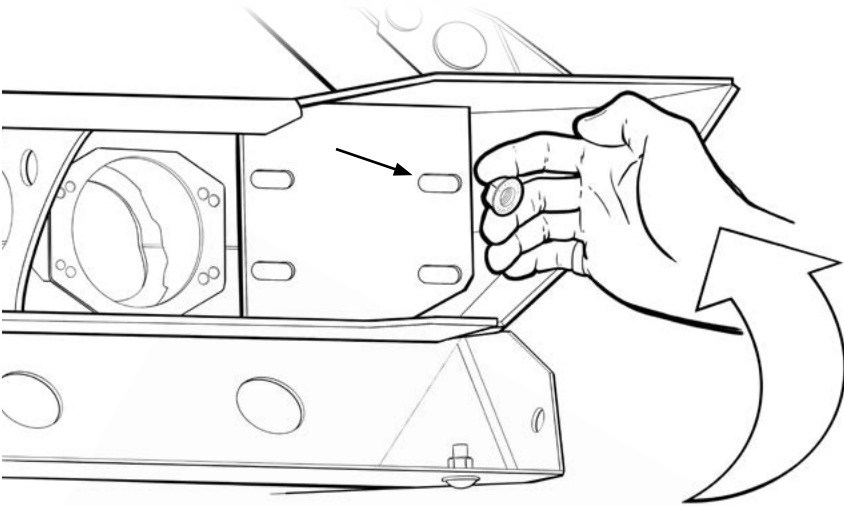

## **STEP 7 :**

HOLD A NUT BETWEEN YOUR FINGERS AND "HOOK" YOUR HAND, REACHING BEHIND THE MOUNT PLATE TO START THE OUTSIDE CORNER BOLTS.

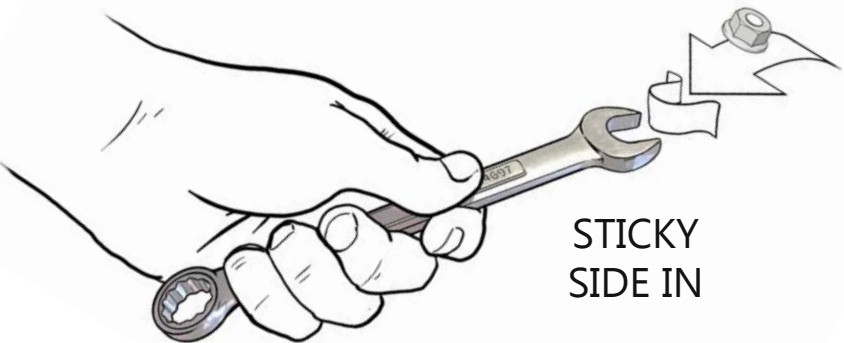

## **STEP 8 :**

GRAB A PIECE OF TAPE AND STICK IT TO THE INSIDE OF THE WRENCH, TO ENSURE THE NUT FITS SNUGLY AND DOES NOT FALL OUT.



## **STEP 9 :**

PLACE A NUT INTO THE WRENCH, THEN PLACE THE WRENCH INTO THE ACCESS SLOT. ALIGN THE NUT WITH THE TOP CORNER BOLT.



## **STEP 10 :**

ALIGN THE NUT WITH TOP CORNER BOLT YOU INSERTED EARLIER, THEN HAND-TIGHTEN IT.

REPEAT STEPS 7+8 ON THE OPPOSITE CORNER BOLT.



## **STEP 11 :**

- CONTINUE TO USE THE TAPE+WRENCH TO HAND-TIGHTEN THE REST OF THE MOUNTING BOLTS.

- REACH YOUR HAND THROUGH THE BACK OPENINGS TO FEEL FOR THE BOLTS.



## **STEP 12 :**

- MAKE SURE THE BUMPER IS CENTERED, WITH THE OUTER EDGES MATCHING UP TO THE GRILLE.

-VERTICAL ADJUSTMENTS CAN BE DONE AT THIS TIME, WITH ABOUT 1" OF TRAVEL AVAILABLE

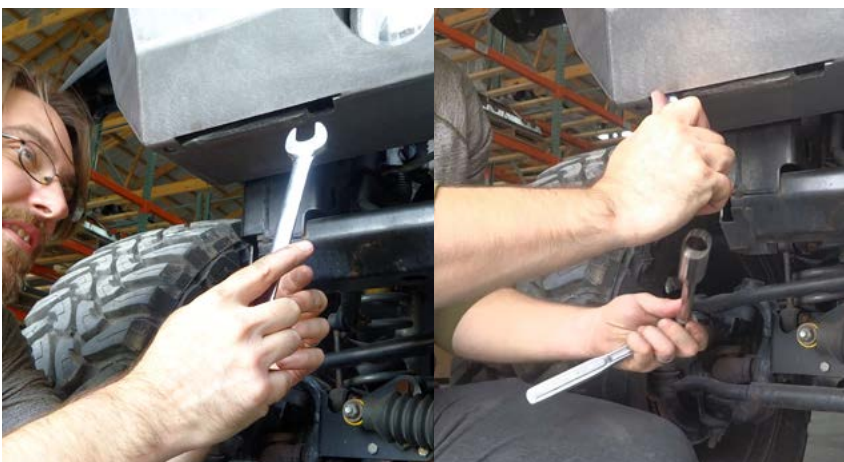

## **STEP 13 :**

- ONCE ALL THE BOLTS ARE HAND-TIGHT, THE TAPE CAN BE REMOVED AND THE WRENCH AND SOCKET CAN BE USED TO TIGHTEN THEM THE REST OF THE WAY.

\*IF YOU'RE NOT USING A WINCH, SKIP STEPS 14 - 16.



## **STEP 14 :**

- PLACE THE WINCH AND FAIRLEAD OVER THE BULLGUARD AND DOWN ONTO THE BUMPER.



## **STEP 15 :**

- LINE UP THE HOLES IN THE WINCH WITH THE SLOTTED HOLES ON TOP OF THE BUMPER. YOU SHOULD BE ABLE TO SEE DIRECTLY THROUGH THE HOLES.



## **STEP 16 :**

- INSERT THE FOUR WINCH MOUNT BOLTS INTO THE OPENINGS AND TIGHTEN THEM DOWN TO SECURE YOUR WINCH IN PLACE.



## **STEP 17 :**

- THIS CONCLUDES THE DESTROYER SERIES FRONT BUMPER INSTALLATION, YOUR PRODUCT SHOULD BE MOUNTED AND READY TO USE.

- FOR SKIDPLATE USERS, FOLLOW ACCESSORY DIRECTIONS.

ITEM NO.	PART NUMBER	DESCRIPTION	WITH BULL BAR/ QTY.
1	4JFB0720-02BS	DESTROYER SERIES FULL WIDTH BUMPER WELDMENT W/BULL BAR - BARE STEEL OPTION	1
	4JFB0720-02BP	DESTROYER SERIES FULL WIDTH BUMPER WELDMENT W/BULL BAR - BLACK POWDER COAT OPTION	1
2	LOD logo	Logo Plate	1

**HARDWARE**

ITEM NO.	PART NUMBER	DESCRIPTION	WITH BULL BAR/ QTY.
3	HB431424ZPGR5	HEX BOLT 7/16-14 X 1.50 HEX BOLT ZINC PLATE GR5	8
4	FW4318ZP	FLAT WASHER Ø7/16 X 1.25" ZINC PLATED	8
5	HFN4314ZP	HEX FLANGE NUT 7/16-14 ZINC PLATE	8
6	HH081808SDZP	HEX HEAD #8 X .50 SELF DRILLING SCREW ZINC PLATE	8

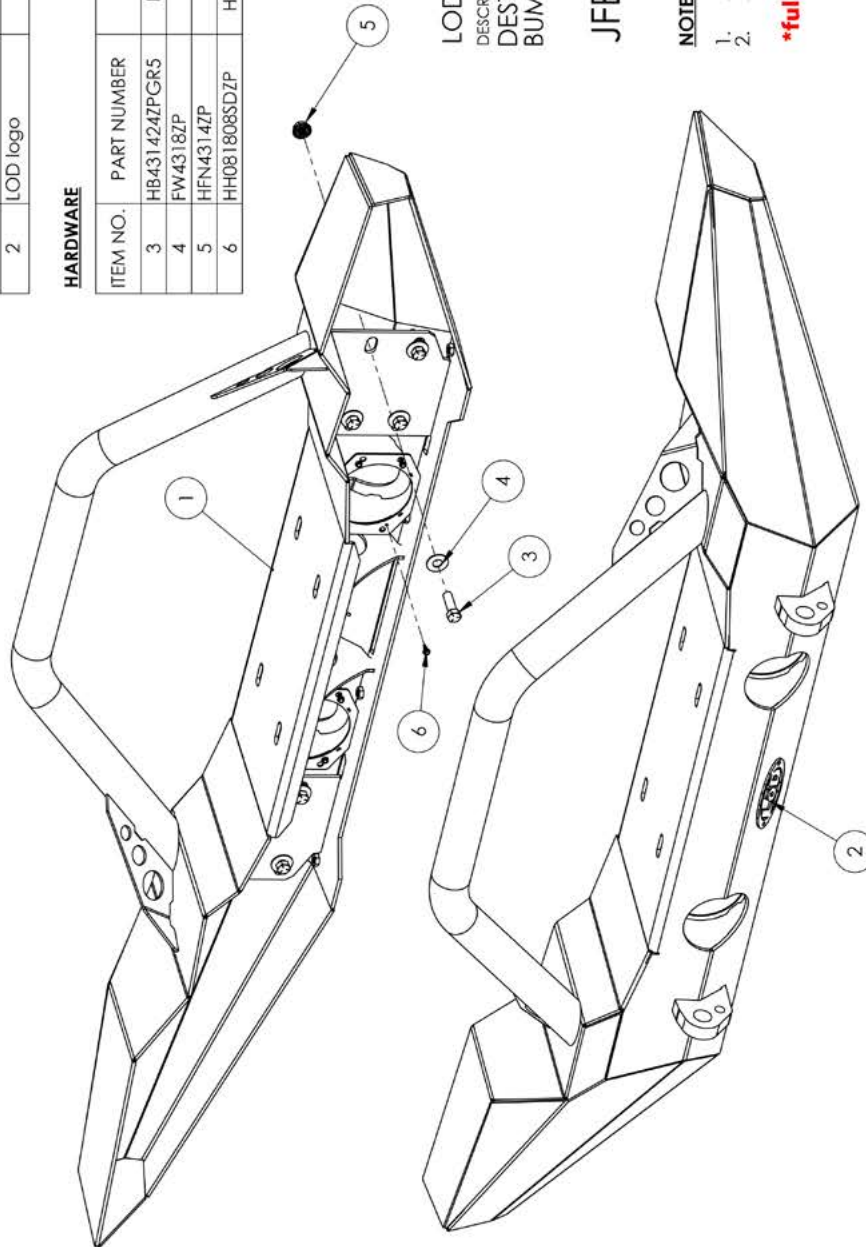

LOD LLC.

DESCRIPTION:

DESTROYER FULL WIDTH FRONT BUMPER WITH BULL BAR

JFB07-SEE NOTE

NOTES:

1. JFB0722 = BARE STEEL OPTION
2. JFB0723 = BLACK POWDER COAT OPTION

**\*fullwidth shown with bullbar\***



**JK Jeep**  
**Destroyer Series**  
 Front Bumper  
 Shipping Sheet  
 Packaged by:

\_\_\_\_\_

On:

\_\_\_\_\_

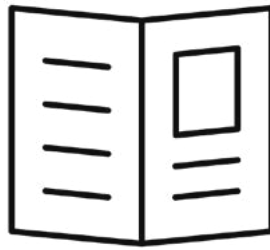

Install Instruction Booklet

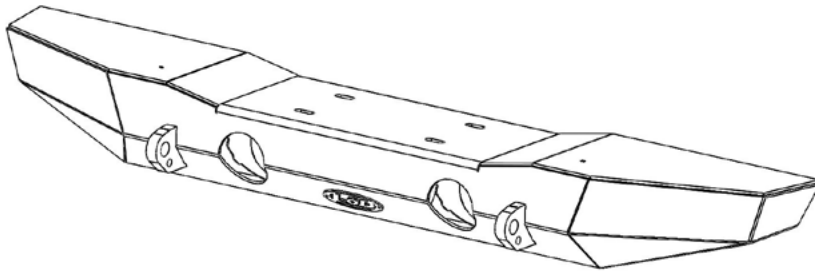

Bumper - style may vary

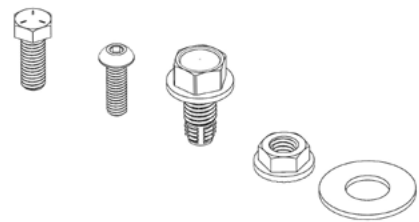

Hardware Kit  
 (contents may vary)





**JK Jeep  
Destroyer Series**  
Front Bumper  
Hardware Sheet

Packaged by:

\_\_\_\_\_

On:

\_\_\_\_\_

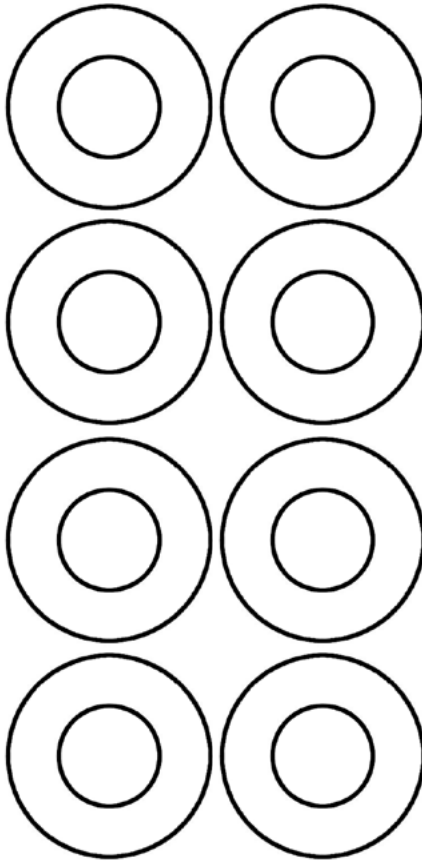

7/16 Washers

**(x8)**

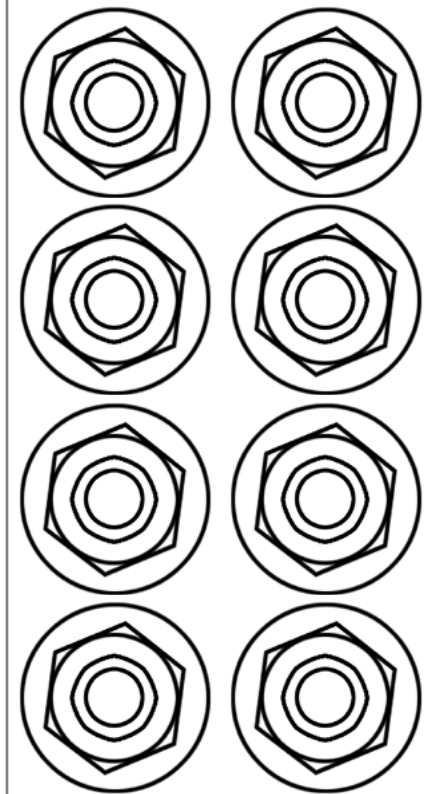

7/16" Flange Nuts

**(x8)**

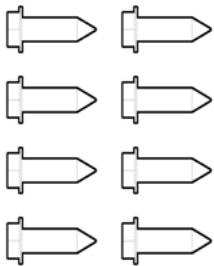

#8 Screw

**(x8)**

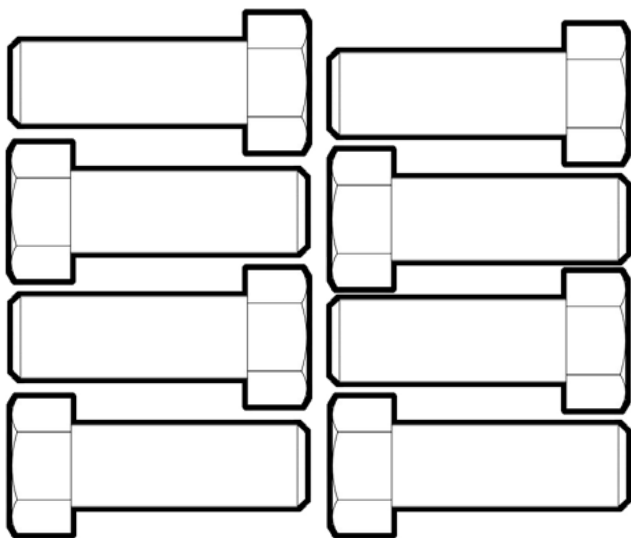

7/16 (14)  
x 1.5" Hex Bolts

**(x8)**

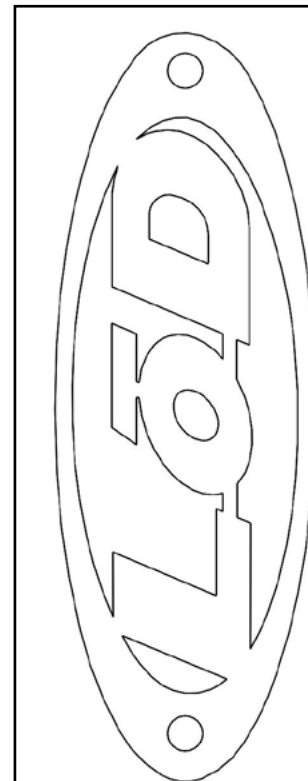

LoD Logo Plate

**(x1)**