



DESTROYER FRONT BUMPER INSTALL



STEP 1: GATHER YOUR TOOLS AND LAY OUT YOUR PARTS...

Tools Required:

- Utility knife
- 11/16" Deep socket
- Ratchet
- 11/16" Crescent wrench
- Ratchet Extension
- 1/4" socket
- Electrical tape

Hardware Provided:

- Eight (7/16"-14 x 1.25") mounting bolts
- Eight (7/16"-14) flange nuts
- Four (7/16") washers
- Eight (#8 Size) screws

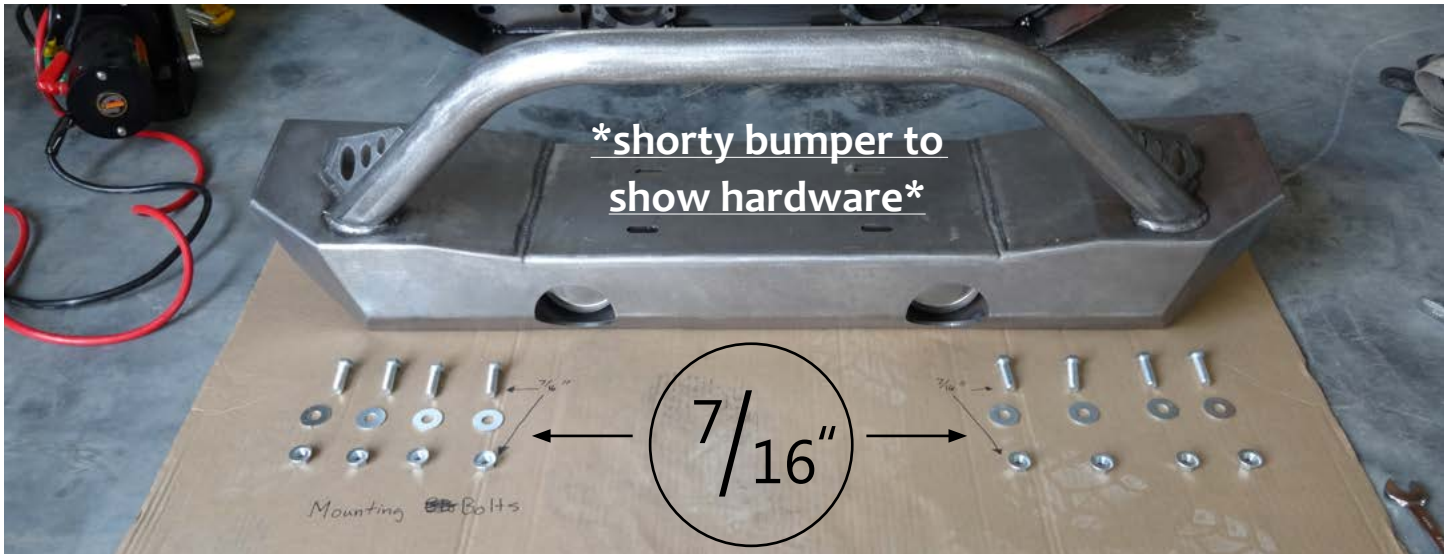



You can now remove the trim strip (2 vertical clips, 4 horizontal, 2 screws) to access the bumper mount bolts.

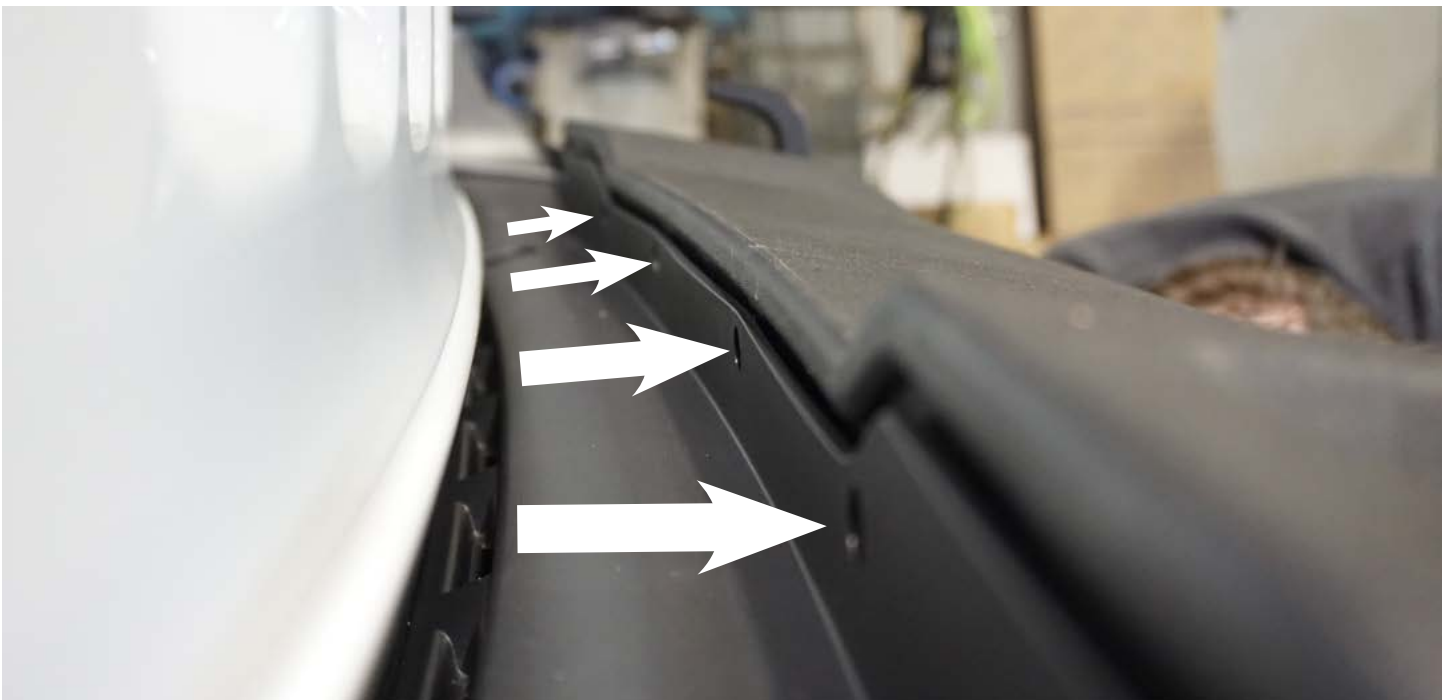

You can now remove the trim strip (2 vertical clips, 4 horizontal, 2 screws) to access the bumper mount bolts.

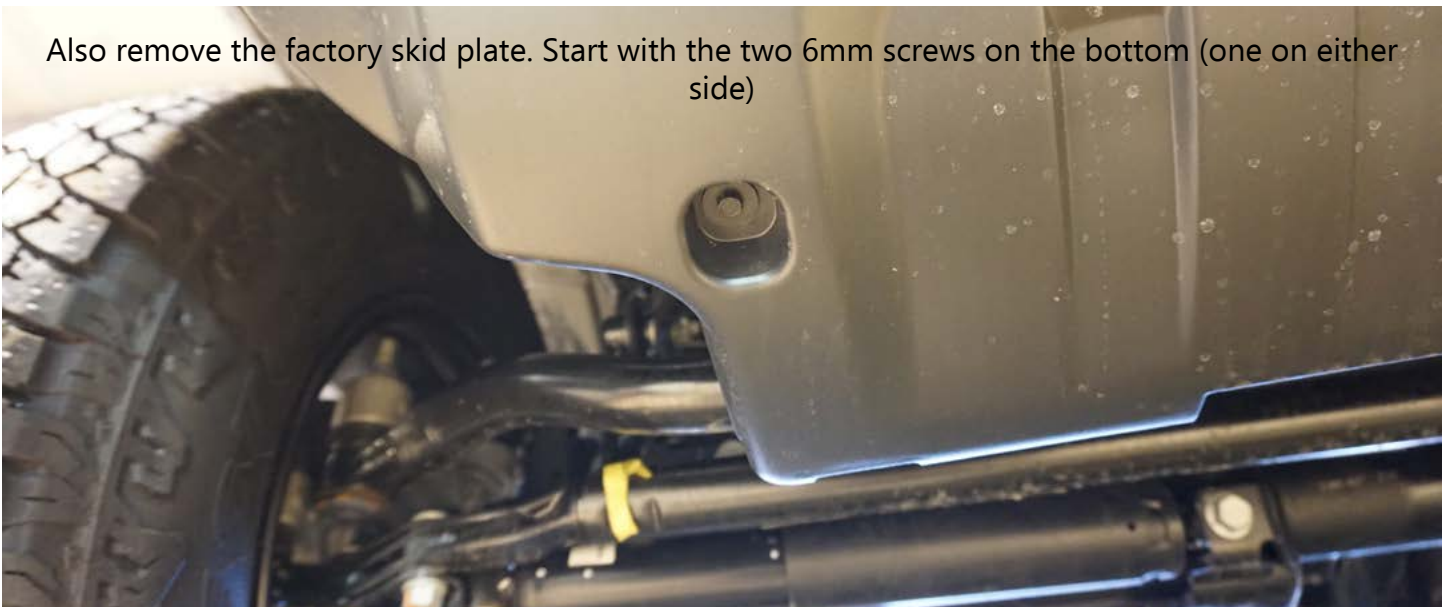
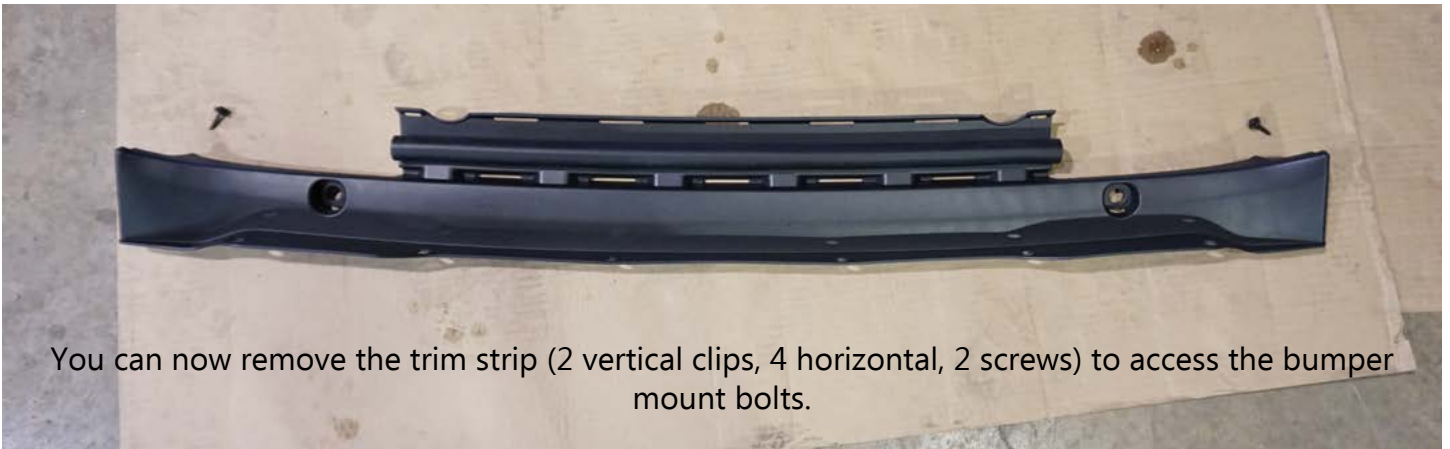



The skidplate is held to the vehicle with eight (8) clips in the front, and the two bolts you just removed, on the bottom.



Also remove the crash bar, there are two bolts holding it on.

After the bolts are removed, you will shift the crash bar slightly up, then pull towards you to remove the tabs out of the opening.

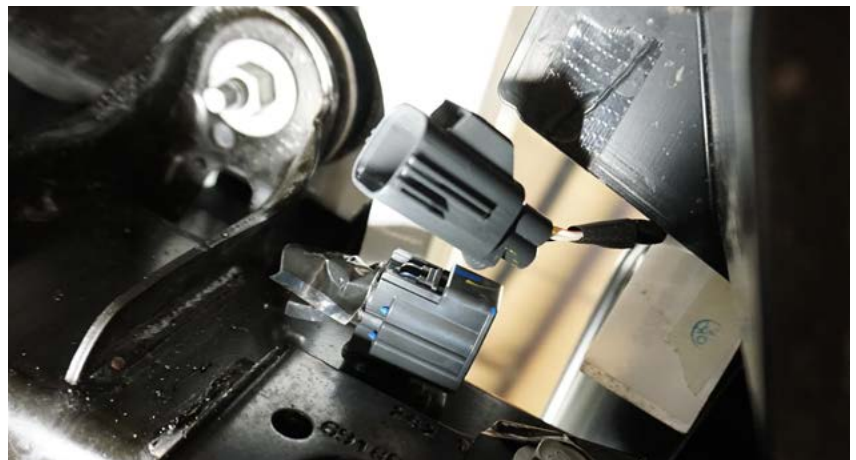
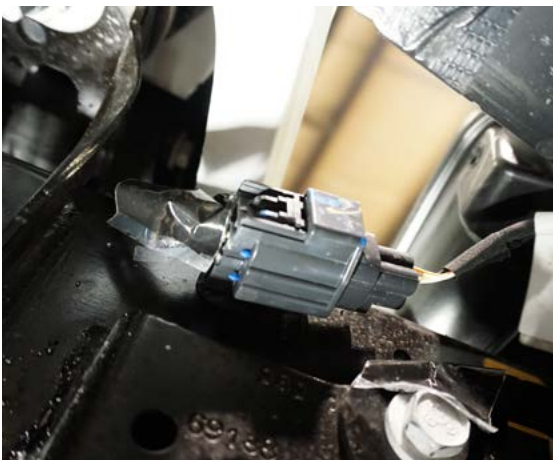

Undo the harness plug that connects the foglights to the vehicle.



The bumper is secured to the vehicle with four (4) bolts on both sides. Remove these and the bumper should come off of the vehicle.

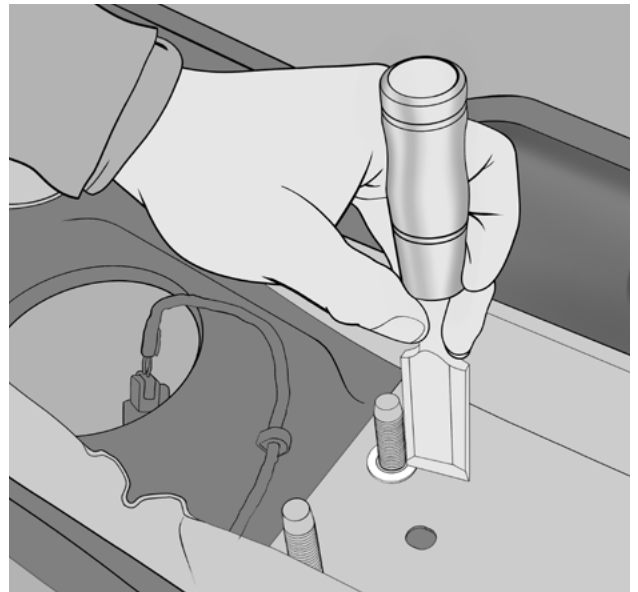

The bolts that hold the bumper together are held in place using locking tooth washers, you can either pry them up with a screwdriver, or cut them off using a sharp chisel or similar tool.

We placed the chisel perpendicular to the surface and gave it one nice hard hit. After this, you should be able to grab the edge with a pair of pliers.

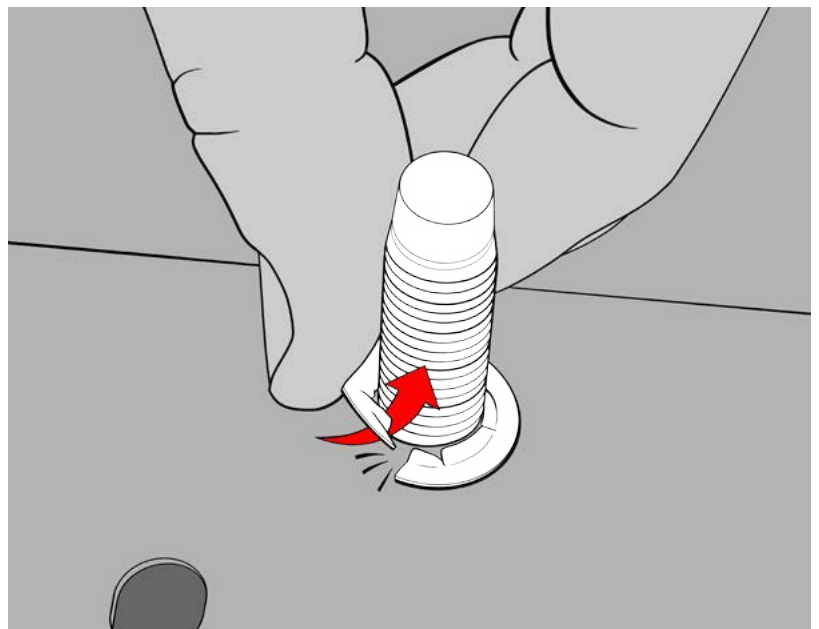



Next, remove the labeled T-25 screws from the bumper, this will allow you to access the foglight, located underneath.

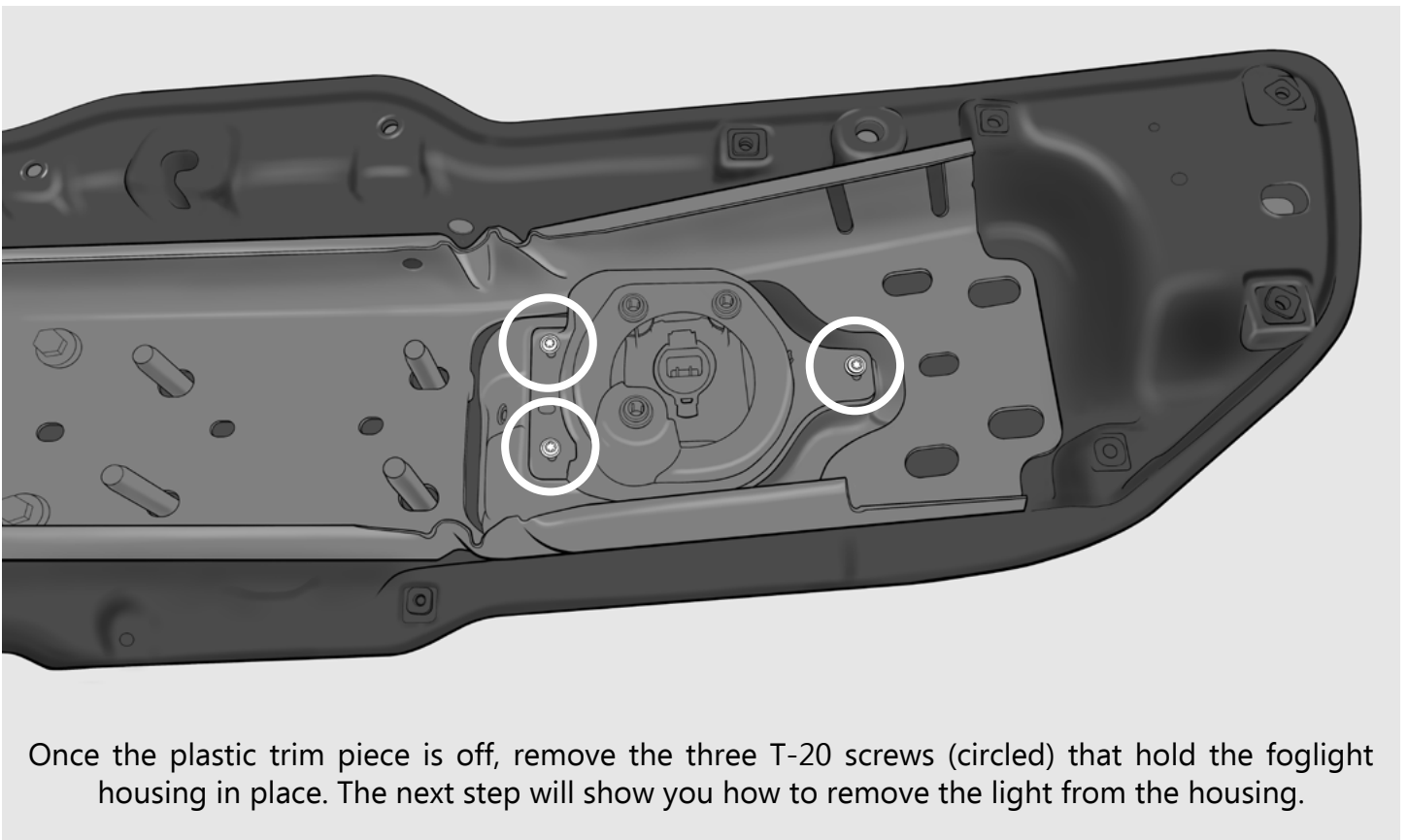

Once the plastic trim piece is off, remove the three T-20 screws (circled) that hold the foglight housing in place. The next step will show you how to remove the light from the housing.

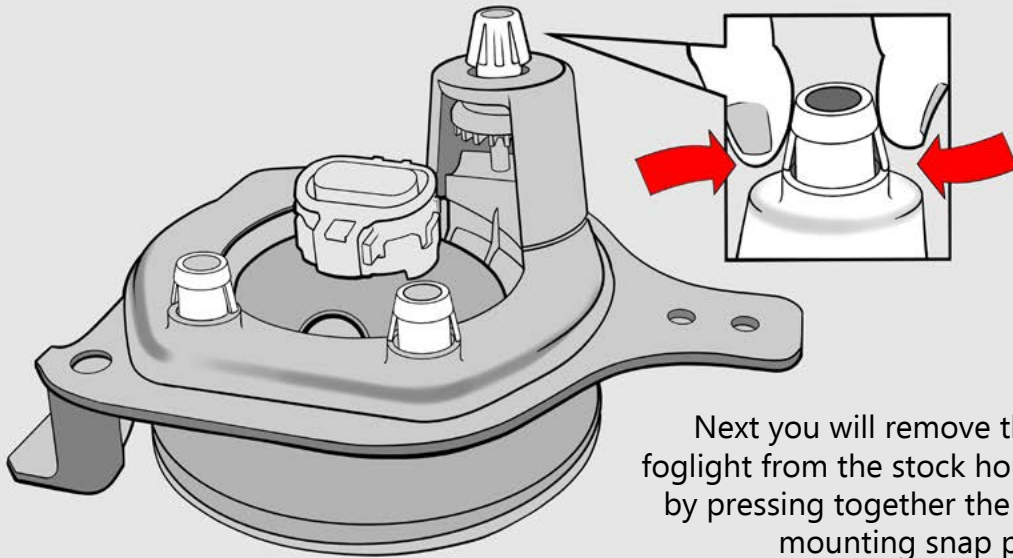

Next you will remove the factory foglight from the stock housing. Do this by pressing together the sides of the mounting snap pins.

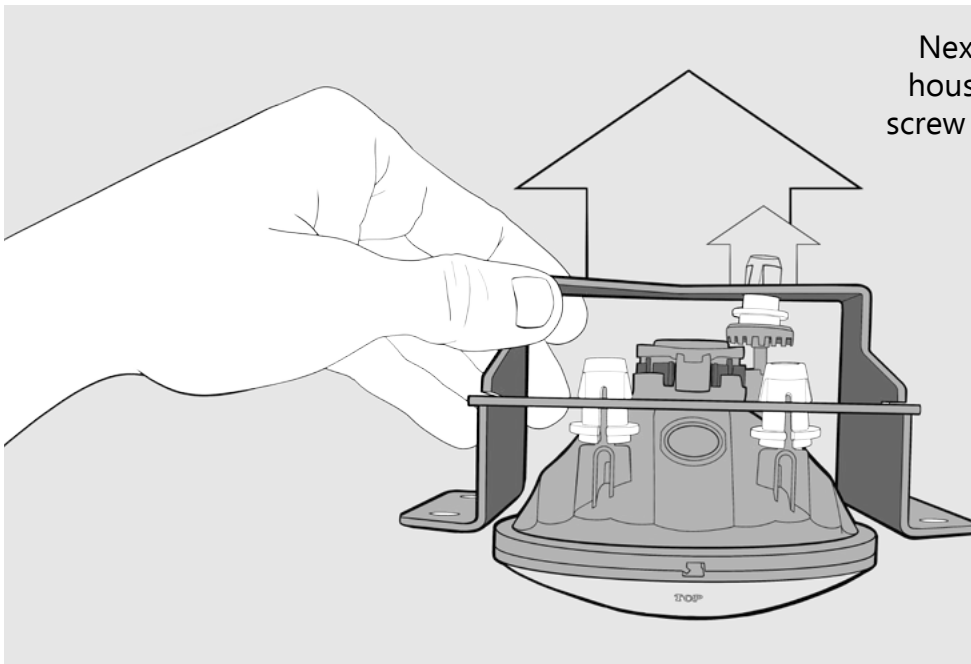

Next, push the light into the new housing, with the long adjustment screw inserting into the farther panel.

The pins should slide into the openings fairly easily.

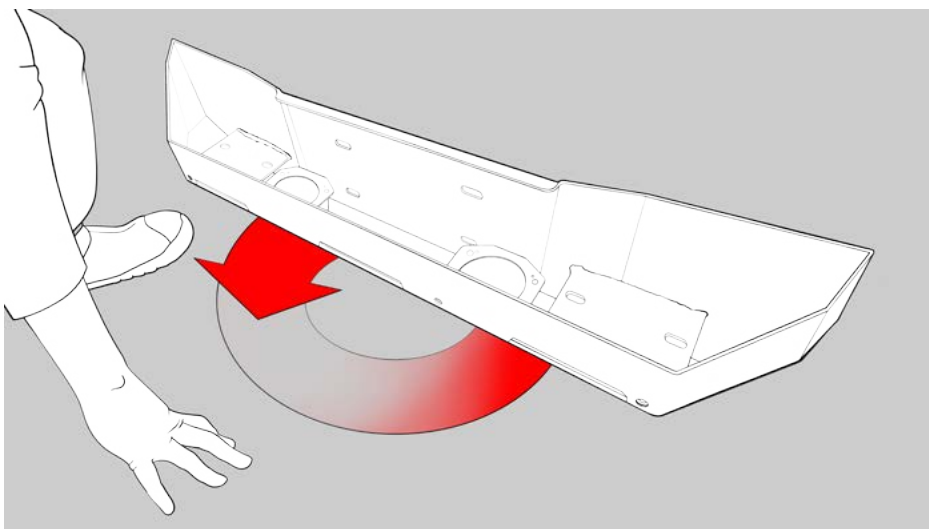

STEP 2:

Lay the Destroyer bumper so the top is facing away from you, so you can insert the factory foglights.

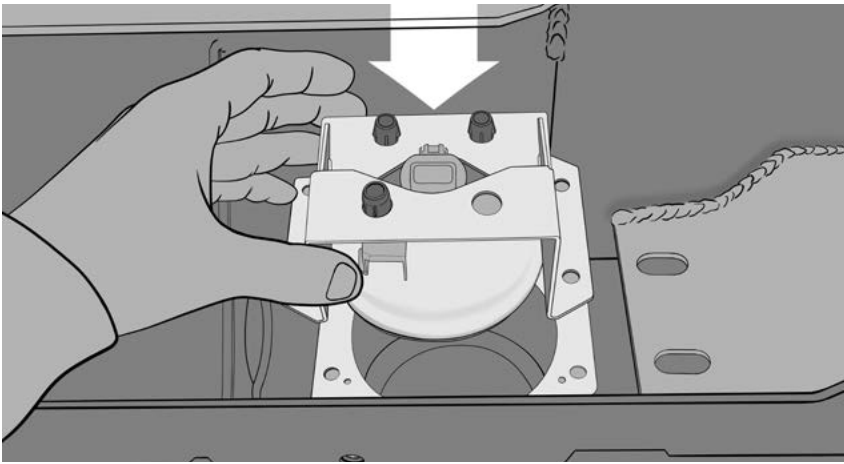

STEP 3 :

Line up the holes and attach the lights with the (8) provided 1/4" -20 X 0.75" Hex head hardware.

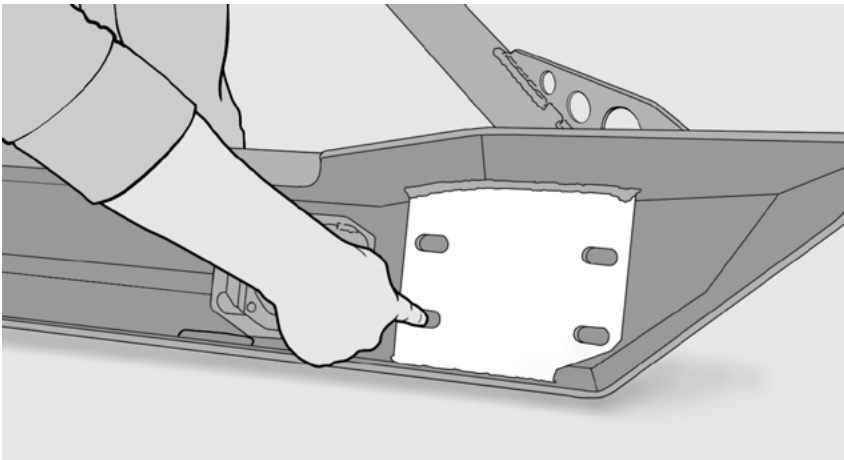

STEP 5 :

LOCATE THE MOUNTING HOLES AND LIFT UP THE BUMPER TO ALIGN THE MOUNTING HOLES ON THE BUMPER AND THE VEHICLE FRAME.

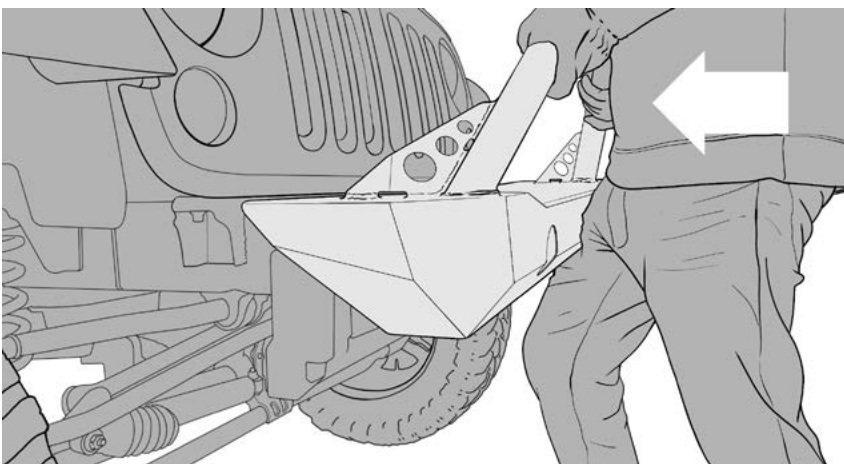

STEP :

GENTLY SLIDE THE BUMPER OVER THE FRAME MOUNTS AND SLOWLY MOVE IT FORWARD, LETTING IT REST ON TOP OF THE FRAME.

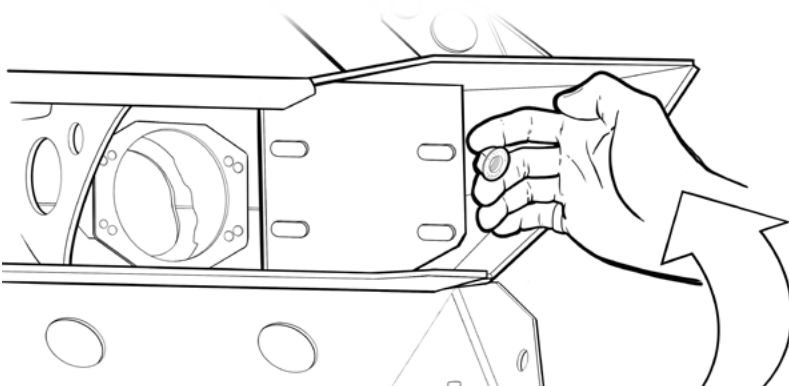

STEP 7 :

HOLD A BOLT BETWEEN YOUR FINGERS AND "HOOK" YOUR HAND, REACHING BEHIND THE MOUNT PLATE TO START THE OUTSIDE CORNER BOLTS.

EACH MOUNT WILL HAVE 4 BOLTS.

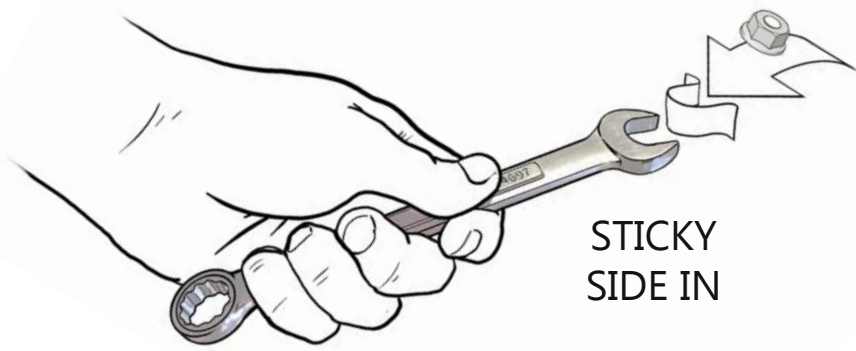

STEP 8 :

GRAB A PIECE OF TAPE AND STICK IT TO THE INSIDE OF THE WRENCH, TO ENSURE THE NUT FITS SNUGLY AND DOES NOT FALL OUT.



STEP 9 :

PLACE A NUT INTO THE WRENCH, THEN PLACE THE WRENCH INTO THE ACCESS SLOT. ALIGN THE NUT WITH THE TOP CORNER BOLT.



STEP 10 :

ALIGN THE NUT WITH TOP CORNER BOLT YOU INSERTED EARLIER, THEN HAND-TIGHTEN IT.

REPEAT STEPS 7+8 ON THE OPPOSITE CORNER BOLT.



STEP 11 :

- CONTINUE TO USE THE TAPE+WRENCH TO HAND-TIGHTEN THE REST OF THE MOUNTING BOLTS.

- REACH YOUR HAND THROUGH THE BACK OPENINGS TO FEEL FOR THE BOLTS.



STEP 12 :

- MAKE SURE THE BUMPER IS CENTERED, WITH THE OUTER EDGES MATCHING UP TO THE GRILLE.

-VERTICAL ADJUSTMENTS CAN BE DONE AT THIS TIME, WITH ABOUT 1" OF TRAVEL AVAILABLE

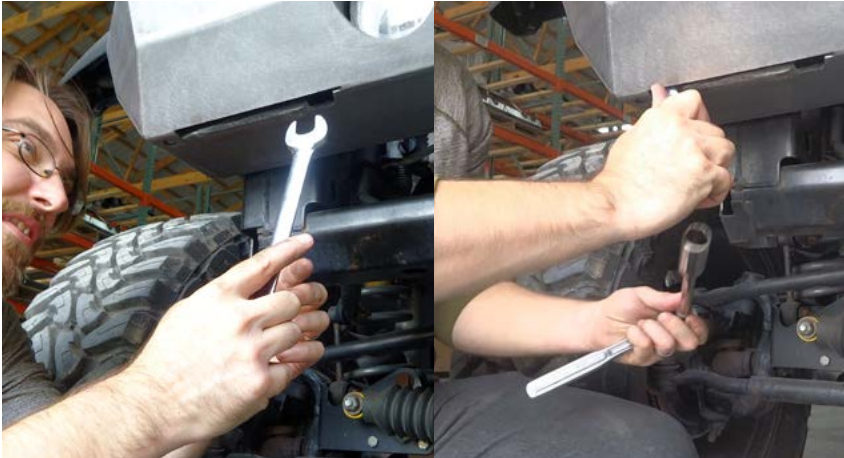

STEP 13 :

- ONCE ALL THE BOLTS ARE HAND-TIGHT, THE TAPE CAN BE REMOVED AND THE WRENCH AND SOCKET CAN BE USED TO TIGHTEN THEM THE REST OF THE WAY.

*IF YOU'RE NOT USING A WINCH, SKIP STEPS 14 - 16.



STEP 14 :

- PLACE THE WINCH AND FAIRLEAD OVER THE BULLGUARD AND DOWN ONTO THE BUMPER.



STEP 15 :

- LINE UP THE HOLES IN THE WINCH WITH THE SLOTTED HOLES ON TOP OF THE BUMPER. YOU SHOULD BE ABLE TO SEE DIRECTLY THROUGH THE HOLES.



STEP 16 :

- INSERT THE FOUR WINCH MOUNT BOLTS INTO THE OPENINGS AND TIGHTEN THEM DOWN TO SECURE YOUR WINCH IN PLACE.

STEP 17 :

- THIS CONCLUDES THE DESTROYER SERIES FRONT BUMPER INSTALLATION, YOUR PRODUCT SHOULD BE MOUNTED AND READY TO USE.
- FOR SKIDPLATE USERS, FOLLOW ACCESSORY DIRECTIONS.



ITEM NO.	PART NUMBER	DESCRIPTION	WITH BULL BAR/QTY.
1	4JFB0720-02BS	DESTROYER SERIES FULL WIDTH BUMPER WELDMENT W/BULL BAR - BARE STEEL OPTION	1
	4JFB0720-02BP	DESTROYER SERIES FULL WIDTH BUMPER WELDMENT W/BULL BAR - BLACK POWDER COAT OPTION	1
2	LOD logo	Logo Plate	1

HARDWARE

ITEM NO.	PART NUMBER	DESCRIPTION	WITH BULL BAR/QTY.
3	HB431424ZPGR5	HEX BOLT 7/16-14 X 1.50 HEX BOLT ZINC PLATE GR5	8
4	FW4318ZP	FLAT WASHER Ø7/16 X 1.25" ZINC PLATED	8
5	HFN4314ZP	HEX FLANGE NUT 7/16-14 ZINC PLATE	8
6	4JL1800-01BP	JEEP JL FOG LIGHT BEZEL - BLACK POWDER COAT OPTION	2
7	HB252012ZPGR5	HEX BOLT 1/4-20 X .75 HEX BOLT ZINC PLATE GR5	8
8	HN2520ZPGR5	HEX NUT 1/4-20 ZINC PLATED GR5	8
9	FW2510ZP	FLAT WASHER Ø1/4" X .625 ZINC PLATE	16
10	FW3814ZP	FLAT WASHER Ø3/8" X .875 ZINC PLATE	12

LOD LLC.

DESCRIPTION:

DESTROYER FULL WIDTH FRONT BUMPER WITH BULL BAR

DWG. NO.

JFB18-SEE NOTE

NOTES:

1. JFB1822 = BARE STEEL OPTION
2. JFB1823 = BLACK POWDER COAT OPTION

fullwidth with bullbar shown

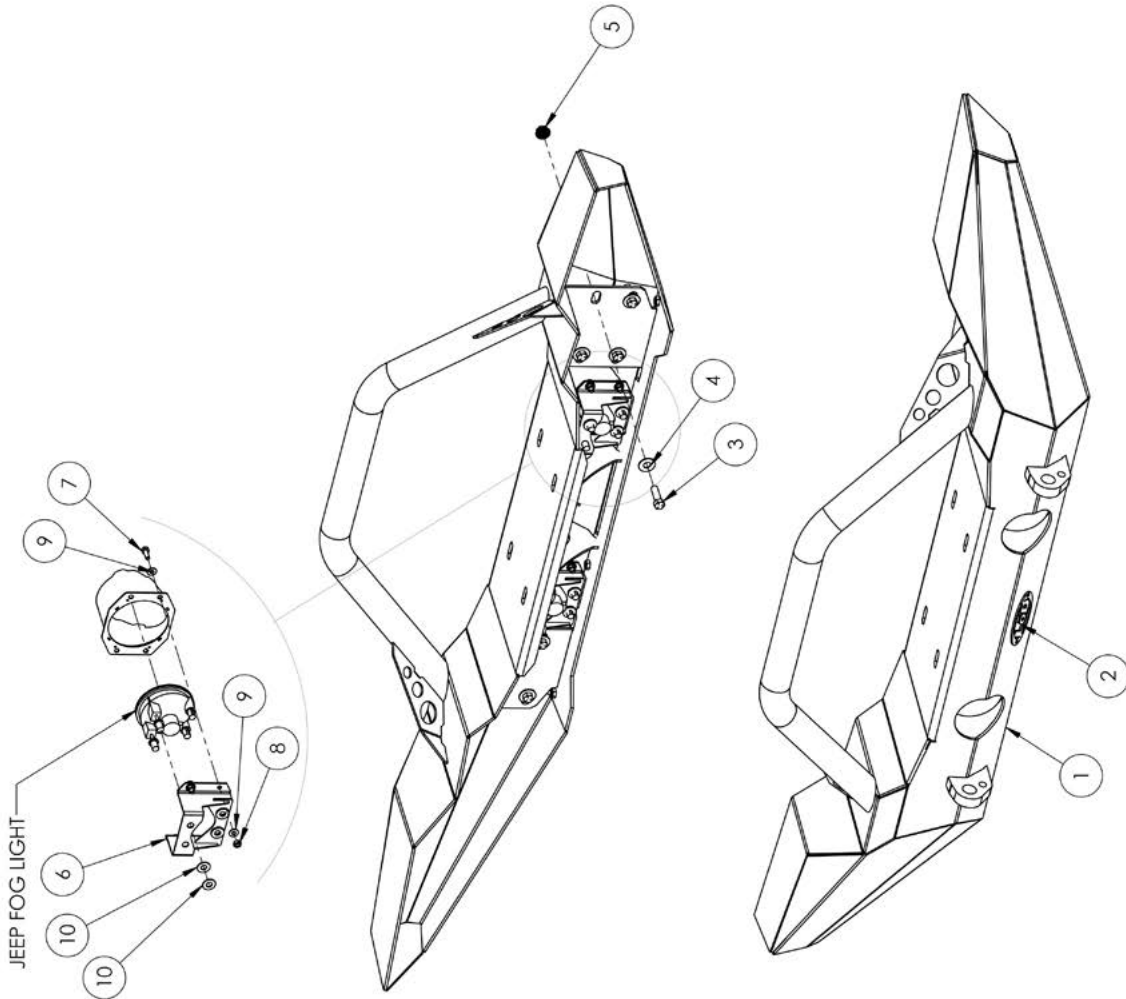



JLU Wrangler
Destroyer Series
Front Bumper
Shipping Slip

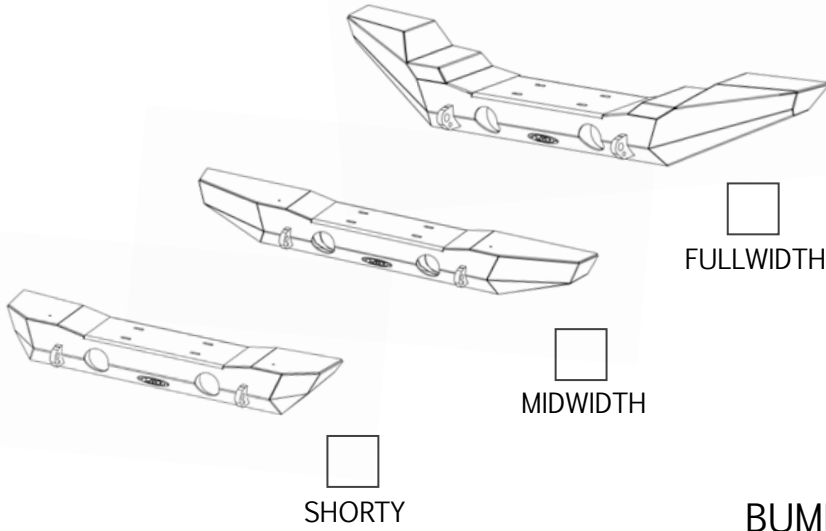

SHORTY

MIDWIDTH

FULLWIDTH

BUMPER
SIZE

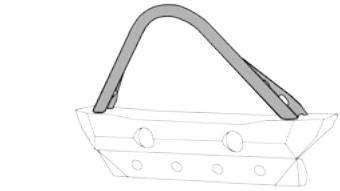

ADD STINGER
only available on shorty

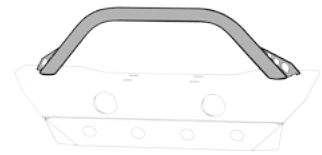

ADD BULLBAR

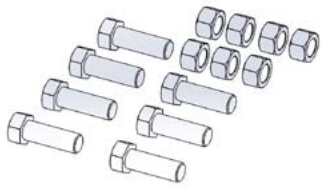

Hardware Kit
(Contents may vary)

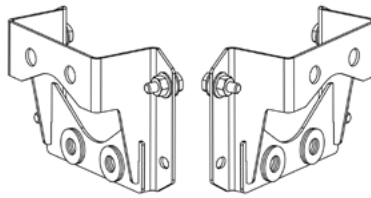

JL Wrangler Bezels

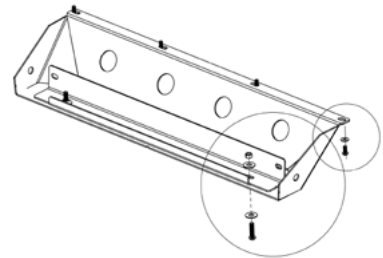

Skidplate



Destroyer Front Bumper Shipping Slip

*please check contents when
opening/assembling package

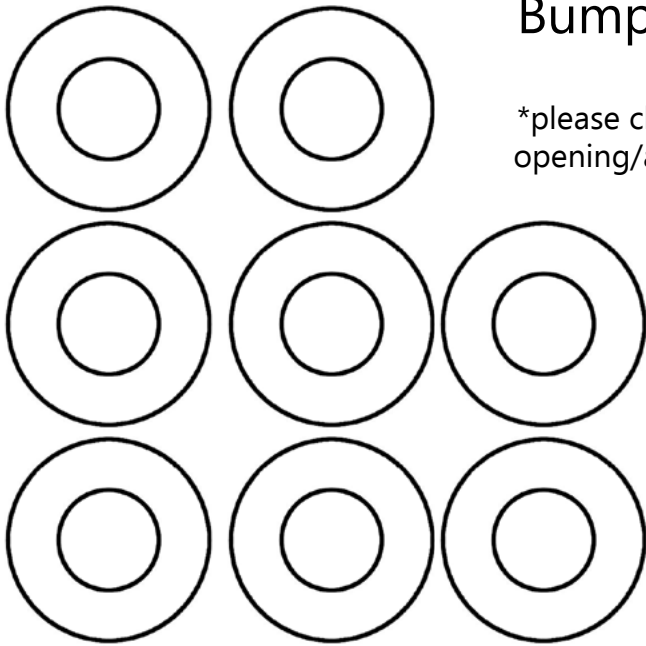

7/16 Washers
(x8)

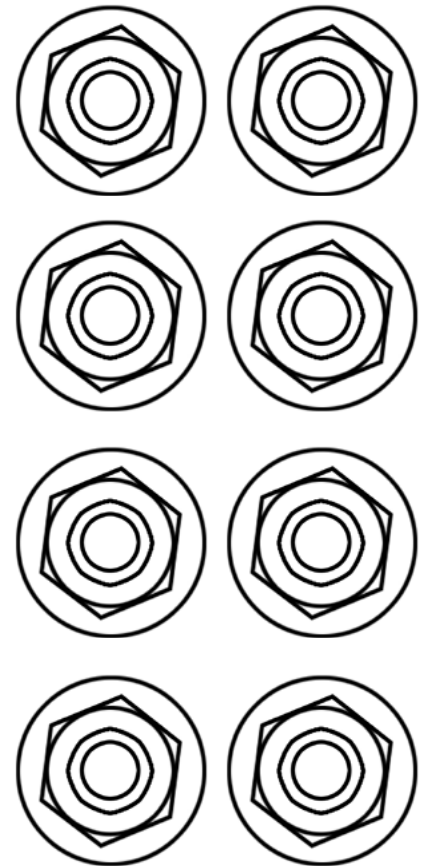

7/16" Flange Nuts
(x8)

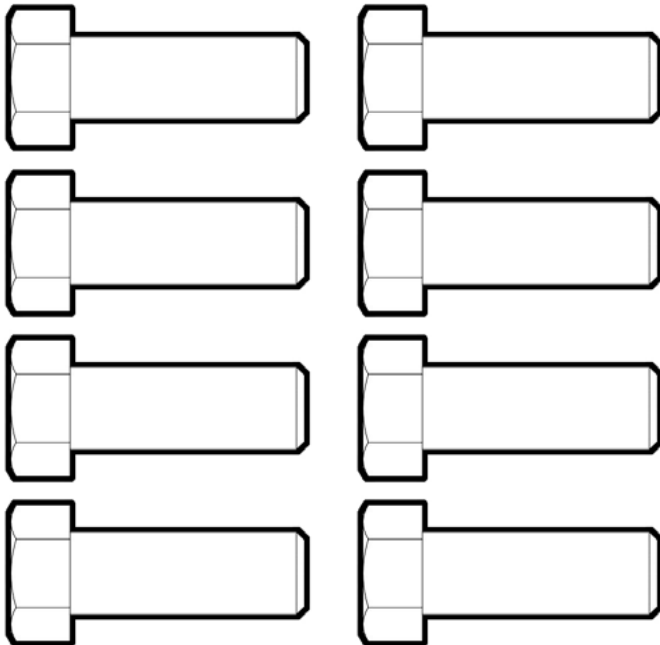

7/16 (14)
x 1.5" Hex Bolts
(x8)

Assembled By : _____

Date : _____

1/4-20
Hex Nut

(x8)

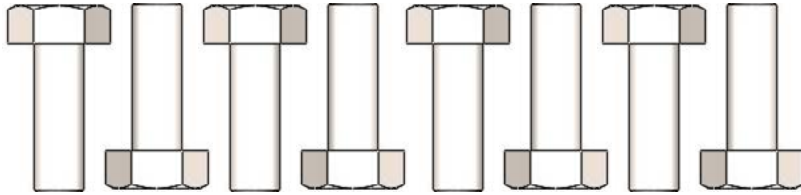
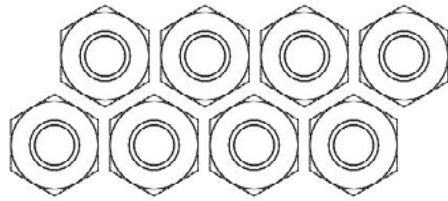

1/4-20 x 0.75"
Hex Bolt

(x8)

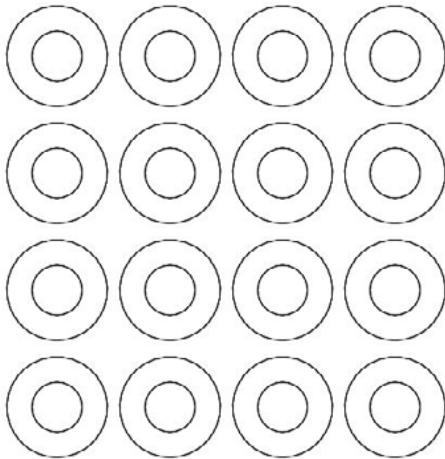

1/4"
Washers

(x16)

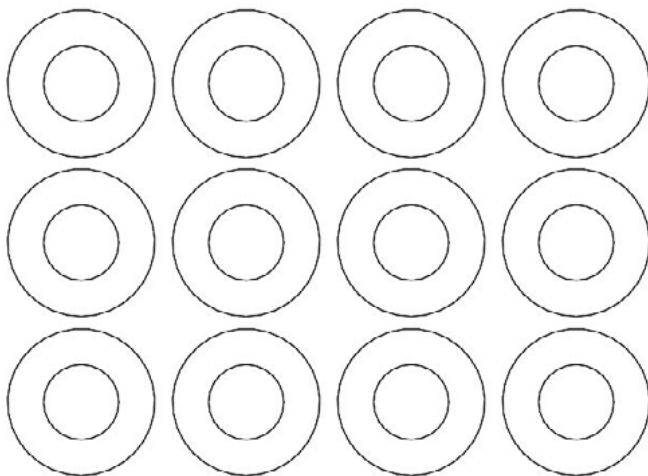
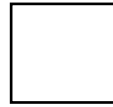

3/8"
Washers

(x12)



Destroyer Front Skidplate Shipping Slip

*please check contents when
opening/assembling package

3/8"x1.5" Buttonhead

(x2)

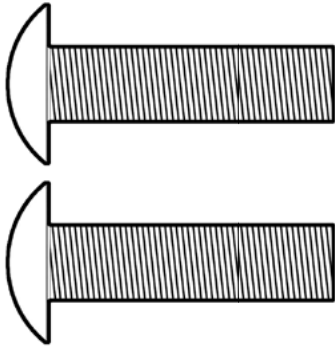

7/16" Washers

(x4)

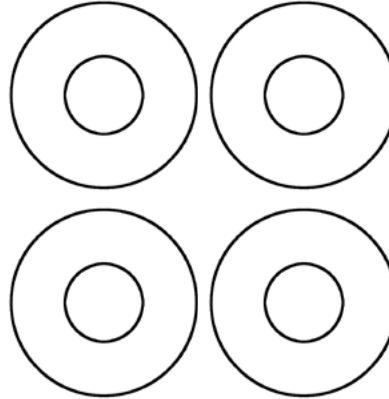

3/8" Nuts

(x2)

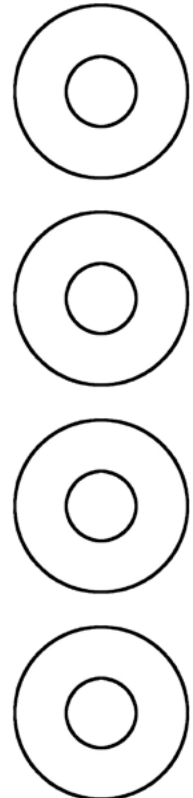
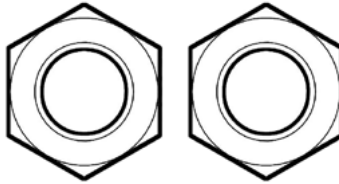

5/16"x0.75 Buttonhead

(x4)



Assembled By : _____

Date : _____

5/16" Washers

(x4)

