

SPARE TIRE CARRIER DELETE

07-18 JEEP JK

TSJK-01



TOOLS REQUIRED

- 2.5mm, 4mm Allen bits
- 4mm, 10mm, 13mm sockets
- Phillips Screw driver
- Wire cutters
- Wire crimps
- Safety Glasses

SKILL LEVEL

- Novice/Intermediate
 - 1 person
- Little skill level required, you can easily install it by yourself.

TIME REQUIRED

- 2.5 Hours
- Time to install this should only take about two and a half hours.

WARNINGS/CAUTIONS BEFORE STARTING INSTALLATION

Before you install this kit – Read and understand all instructions, warnings, cautions, and notes contained in this installation instruction guide. Consult your vehicle owner's manual for proper disconnection of electrical and lifting of vehicle if required for installation of this product.

This install may require some technical skills and knowledge of basic mechanical work. If you do not feel that you are capable of performing this install please take this product to a trained professional.

After reading this guide please contact us with any questions or concerns before installing product.
Customer Service: 855-680-9595

DV8 Offroad is not responsible for any bodily injury or harm to you or your vehicle as a result of an improper install.

Proper installation of this kit required knowledge of the factory recommended procedures for removal and installation of original equipment components. We recommend that the factory shop manual and any special tools needed to service your vehicle be on hand during the installation. Installation of this kit without proper knowledge of the factory recommended procedures may affect the performance of these components and the safety of the vehicle

- Always wear eye protection when operating power tools

Inspect all contents of this package to make sure product is not damaged and all installation hardware has been included. If parts are missing from kit, please be prepared to provide the following information

1. Name of purchase location
2. Bar Code on side of box
3. Date above bar code
4. Date inside box cover



INSTALLATION MANUAL

Begin by unpacking all items and inspecting for missing pieces or damage. If you have any concerns, please contact the company the product was purchased from. Extra hardware may be included with the product.

HARDWARE INCLUDED

- | | |
|------------------------------|----------------------------------|
| (2) M4x30mm Allen Head Bolts | (4) M6 Lock Nuts |
| (2) M4x15mm Cross Head Bolts | (12) M6 Flat Washers |
| (4) M4 Lock Nuts | (1) Third Brake light |
| (8) M4 Flat Washers | (4) Waterproof Wiring connector |
| (6) M6x14mm Allen Head Bolts | (1) Wiring Connector |
| (4) M6x20mm Allen Head Bolts | (1) License Plate Wiring Harness |
| (4) M6 Split Washers | (3) Tailgate Plugs |



STEP 1 | Remove the spare tire from the vehicle.



INSTALLATION MANUAL

STEP 2 | Open The tailgate and use a trim clip tool to remove the trim panel on the tailgate.

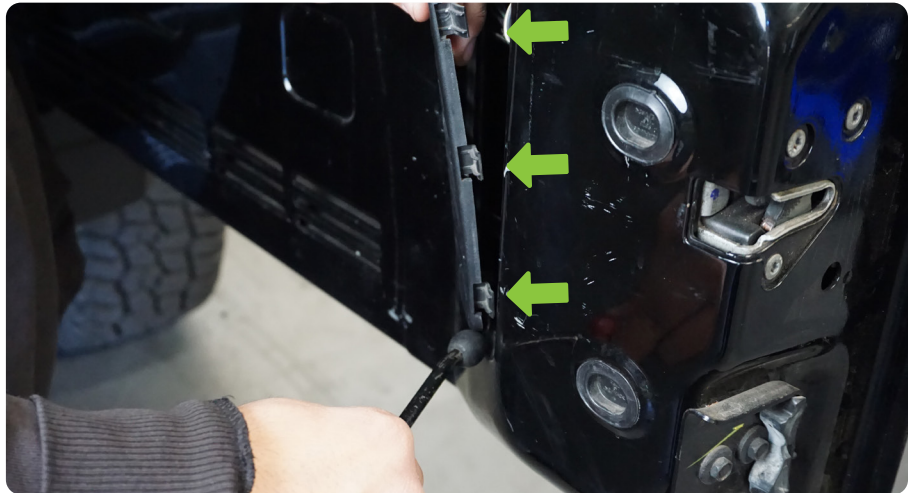

STEP 3 | Disconnect the third brake light wiring harness. Small gray plug shown in image.

Use a trim clip tool, if necessary since plug can become stuck.

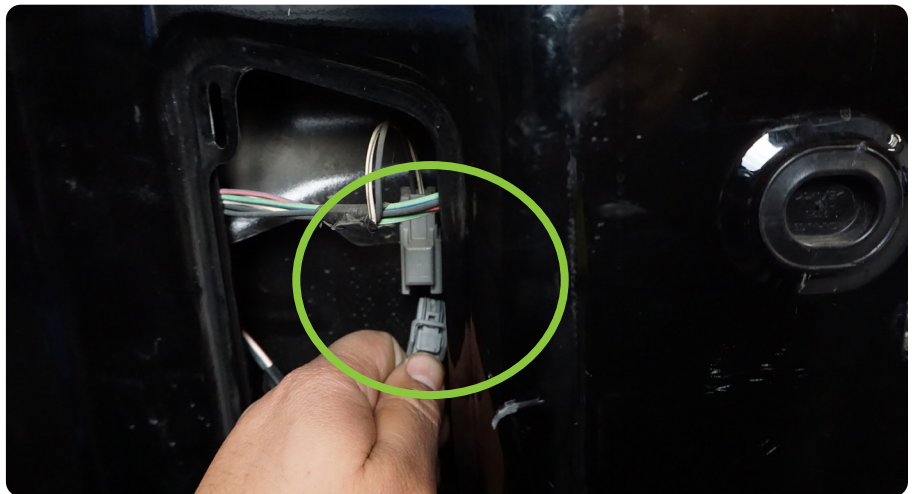

STEP 4 | With the light unplugged, push the rubber grommet holding the wire towards the outside (back) of the vehicle.



INSTALLATION **MANUAL**

STEP 5 | Remove the rubber tire stoppers by pulling them out.

If you must use a trim clip tool, be careful not to scratch the paint.



STEP 6 | Use a 13mm socket to remove the (8) factory bolts securing the tire carrier to the vehicle, set the carrier off to the side.



INSTALLATION MANUAL

STEP 7 | Install the provided foam on the back side of the mounting plate and tire delete.

2 pieces of foam provided. 1 for mounting plate and 1 for tire carrier delete plate

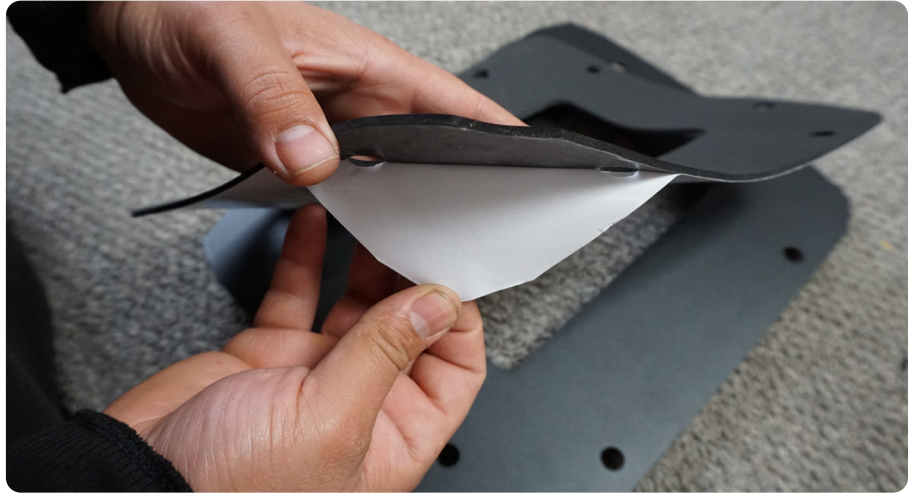

INSTALLATION MANUAL

STEP 8 | Assemble the tire carrier delete face plate. Install the third brake light, license plate light at this time using the provided hardware. These will install from the backside like shown in the image.

Use the M4x30 hardware, a 2.5mm Allen bit/wrench and 4mm socket for the third brake light hardware.

Use the M4x15mm cross head hardware, a 4mm socket and Phillips screw driver for the license plate light.

Use the M6x14mm hardware, a 4mm Allen bit/wrench and 10mm socket for the license plate mounting hardware.



STEP 9 | Route the license plate wiring harness through the tailgate vent as shown.



STEP 10 | Unravel the third brake light factory wiring harness previously disconnected in step 3.



INSTALLATION MANUAL

STEP 11 | Pull the third brake light wiring harness through the tailgate towards the center of the tailgate.

Route the factory third brake light harness and through the tailgate vents along the license plate wiring harness.



STEP 12 | Cut the factory third brake light wiring harness plug off.



STEP 13 | Connect the male end of the provided electrical plug to the third brake light factory wiring harness.

Connect Red wire To White wire.
Connect Black wire to Black wire.



INSTALLATION MANUAL

STEP 14 | Install the mounting plate on to the tailgate using the (8) factory bolts previously removed in step 6 and a 13mm socket.

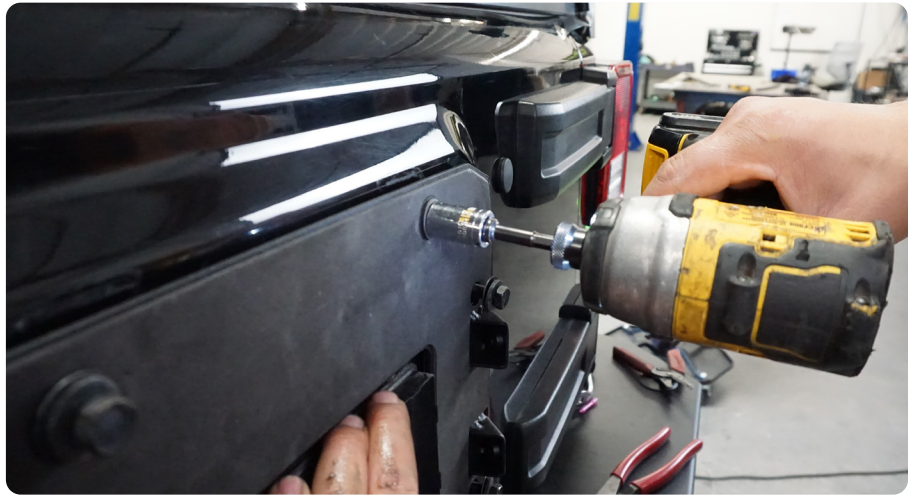

STEP 15 | Connect the provided license plate wiring harness to the license plate light.

Connect the third brake light electrical plugs at this time using the provided butt connectors.



INSTALLATION MANUAL

STEP 16 | Install the tire carrier delete face plate using the provided M6x20mm hardware and a #4 Allen bit.



INSTALLATION MANUAL

STEP 17 | Route the provided license plate wiring into the vehicle and over to the driver side of the vehicle under the carpet or plastic trim of the vehicle.



Push factory License plate light wiring harness back through the body hole and up into the trunk area of vehicle.

We recommend using T-taps/wire taps to connect the provided license plate wiring harness to the factory license plate light harness so no splicing is required.

Connect Red to White wire and Black wire to Black wire.



STEP 18 | Reinstall any and all plastic interior trim panels.



INSTALLATION MANUAL

STEP 19 | Double check that all faceplate hardware is secure and lights are functioning properly.

Congratulations the installation of the DV8 Tire Carrier Delete is now com

